

PRIMINER

VERTICAL MACHINING CENTERS

PRECISE · DYNAMIC · RELIABLE

Top price/performance ratio

High-quality components

Numerous options

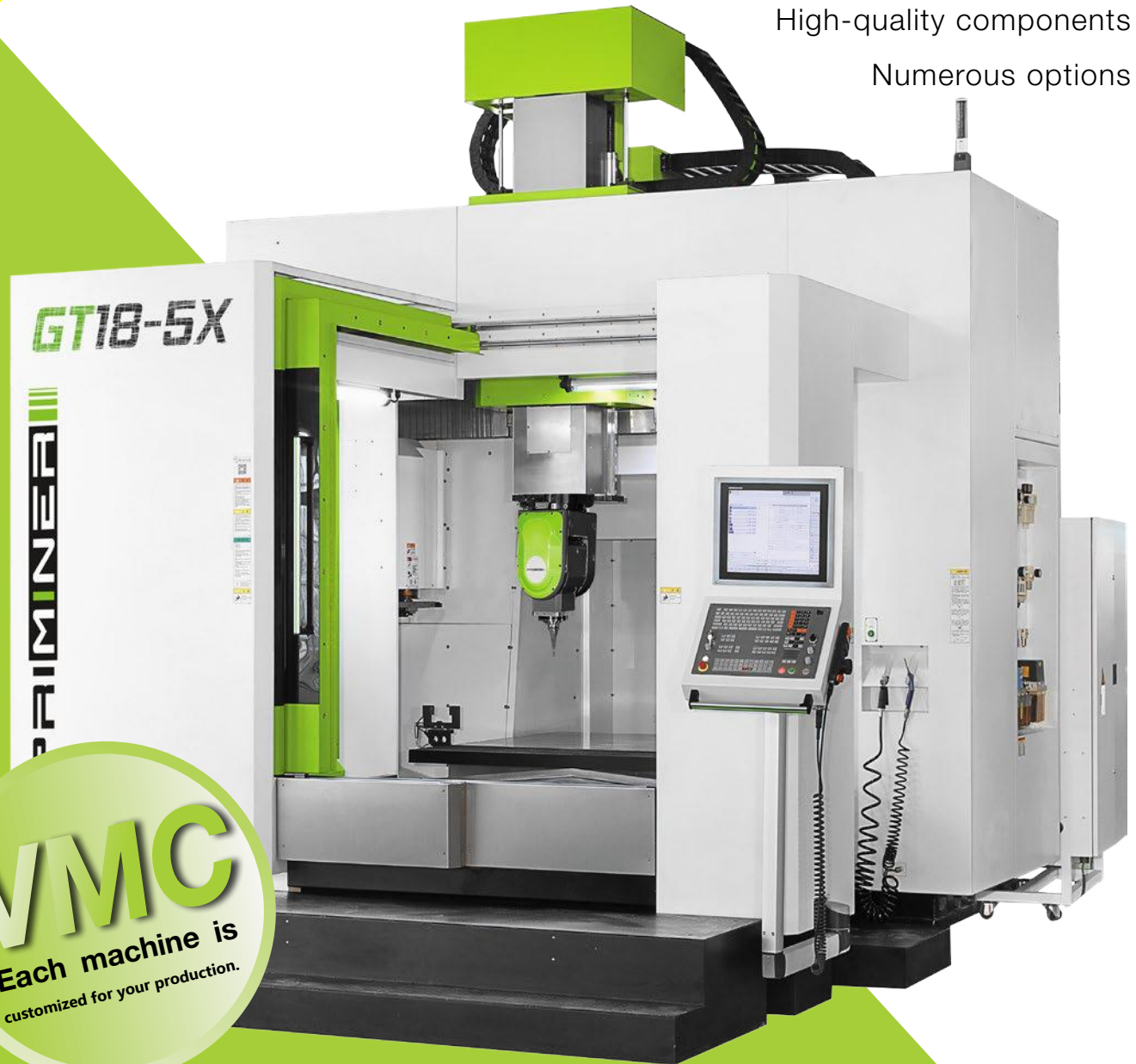

VMC
Each machine is
customized for your production.





PRIMINER

The Company



Jack Chen | CEO Priminer Company Group
Benjamin Kaehlcke | General Manager, Germany



PRIMINER

PRIMINER

PRIMINER



We stay up to date

“Only employees which are regular trained and involved in the development of our production process can understand the requirements of present and future as a whole.” According to Mr. Kaehlcke GM of Priminer Germany. “This is the case for our German and China team members. We have an intensive exchange program between our two major spots, additional to our permanent training course at our global leading sub-suppliers.”





HOW WE DO IT

Consequent QC-management according to international norms, a highly motivated team of specialists, advantages of serial production and reliable top sub-suppliers with global leading positions are columns of our success. An open and result-oriented company culture through all levels is the basement for a permanent high level of our reliability and products.



Our Team

International, competent, highly motivated and always open for new ideas... This is our team. The cooperate culture is a mirror of these attitudes. Our management has got a "open ear" from bottom to top and we practise flat hierarchy.

PRIMIN



PRIMINER



PRIMINER Global TEAM



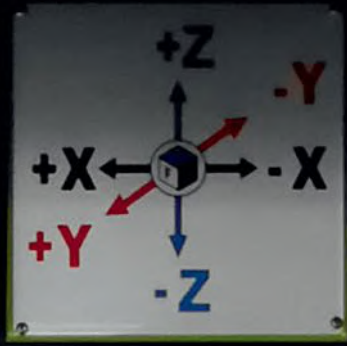

OUR KNOW-HOW FOR YOUR BUSINESS

Technology & Know-how

We think and plan the future already now. A growing in-house R&D department with experienced engineers which develop our machine concepts are our warrantor that we are prepared for the upcoming trends of the machine tools business. We are listening to the market. Flexibility in the matter of CNC controllers is for us a must, here we only go with the market leaders. Without any compromise!





U500

- Gantry design
- Torque motor direct drive rotary table
- Dual drive system with two ballscrews on Y axis to ensure the best dynamic.
- Compact design with minimum floor plan area



Technical Specifications		U500		
Table				
Max. workpiece diameter	mm	Φ700		
Table size	mm	Φ500		
T-slot (width x number x distance)	mm	14 x 5 x 80		
Max. load	kg	500		
Travel				
X/Y/Z Travel	mm	700 / 650 / 450		
A/C Travel	deg	+30° ~ -110° / 360°		
Spindle				
Spindle taper	-	HSK A63	HSK A63	HSK E50
Spindle motor power	kW	21 / 26	20 / 24	15 / 18
Spindle motor torque	Nm	67 / 86	35 / 42	14 / 17.3
Spindle speed	rpm	18000	20000	36000
Spindle nose to table	mm	135-585	110-560	110-560
Feed				
Rapid feed X/Y/Z	m/min	36		
Rotation speed A/C	rpm	100 / 170		
Cutting speed	mm/min	1-12000		
Tool changer				
Number of tools	pcs	32		
Max. tool length	mm	250		
Max. tool diameter	mm	Φ63		
Max. tool weight	kg	4		
Accuracy(VDI 3441 Full travel)				
Positioning accuracy	mm	0.006 (X/Y/Z) 5/3 arc-sec (A/C)		
Repeatability accuracy	mm	0.003 (X/Y/Z) 2.5/2 arc-sec (A/C)		
Dimensions & Weight				
Dimensions	mm	3560x3380x2995		
Weight	kg	9000		

Standard configuration

- ✓ Direct drive rotary table
- ✓ Full enclosed splash guard
- ✓ Built-in spindle HSK A63 20000 rpm
- ✓ 32 pockets tool changer
- ✓ Chain type chip conveyor
- ✓ Air-conditioned electrical cabinet
- ✓ High precision spindle water cooler
- ✓ Linear scales on X/Y/Z axis
- ✓ Rotary encoder on A/C axis
- ✓ Rigid tapping
- ✓ Ethernet ,CF card and USB interface
- ✓ Centralized automatic grease lubrication system
- ✓ Coolant system
- ✓ Air blast during cutting
- ✓ LED working lamp
- ✓ End of program light
- ✓ Electronic handwheel (MPG)
- ✓ Tool box
- ✓ Leveling bolts and blocks
- ✓ Coolant gun
- ✓ Air gun
- ✓ User Manual

Optional configuration

- Built-in spindle HSK A63 18000rpm
- Built-in spindle HSK E50 36000rpm
- CTS Coolant through spindle + ATS
- Oil cooling through ballscrew
- Workpiece probe
- Tool probe
- Dynamic Collision Monitoring (DCM)
- Kinematics
- Oil mist collector
- Minimum Quantity Lubrication system
- Coolant Cooling system
- Extra 200GB SSD program memory

Cutting Area

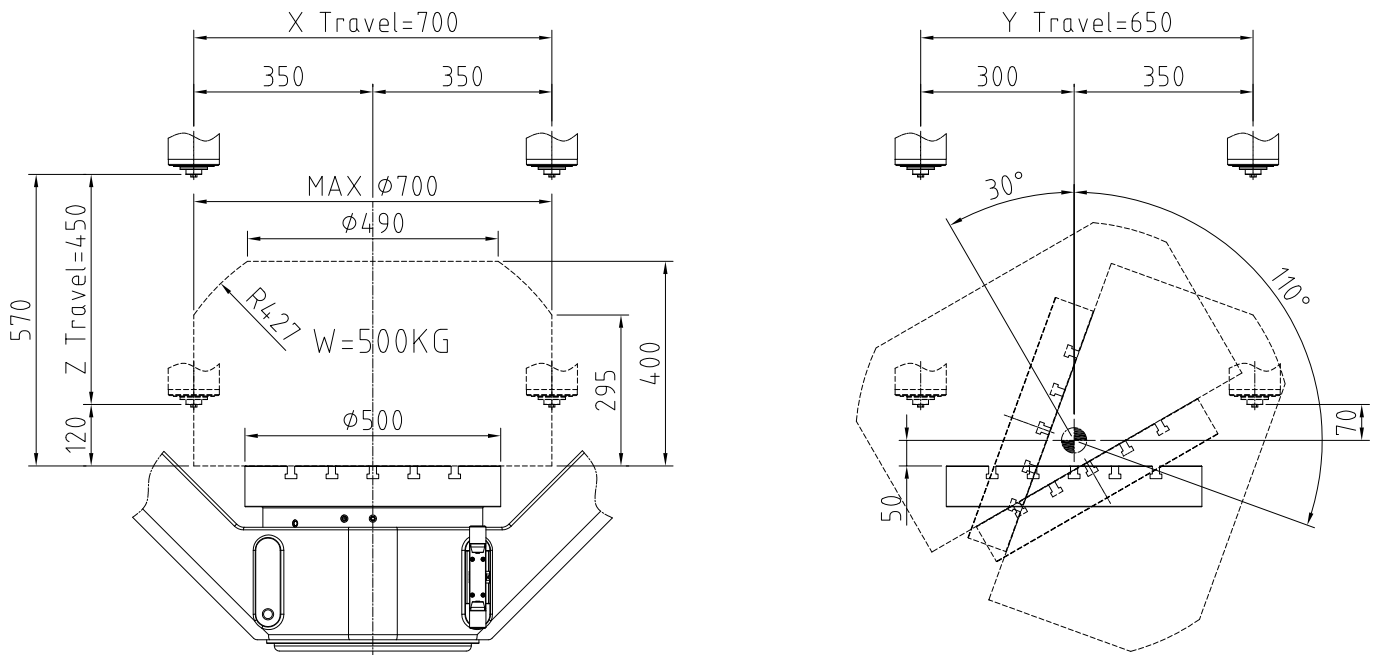

Dimensions

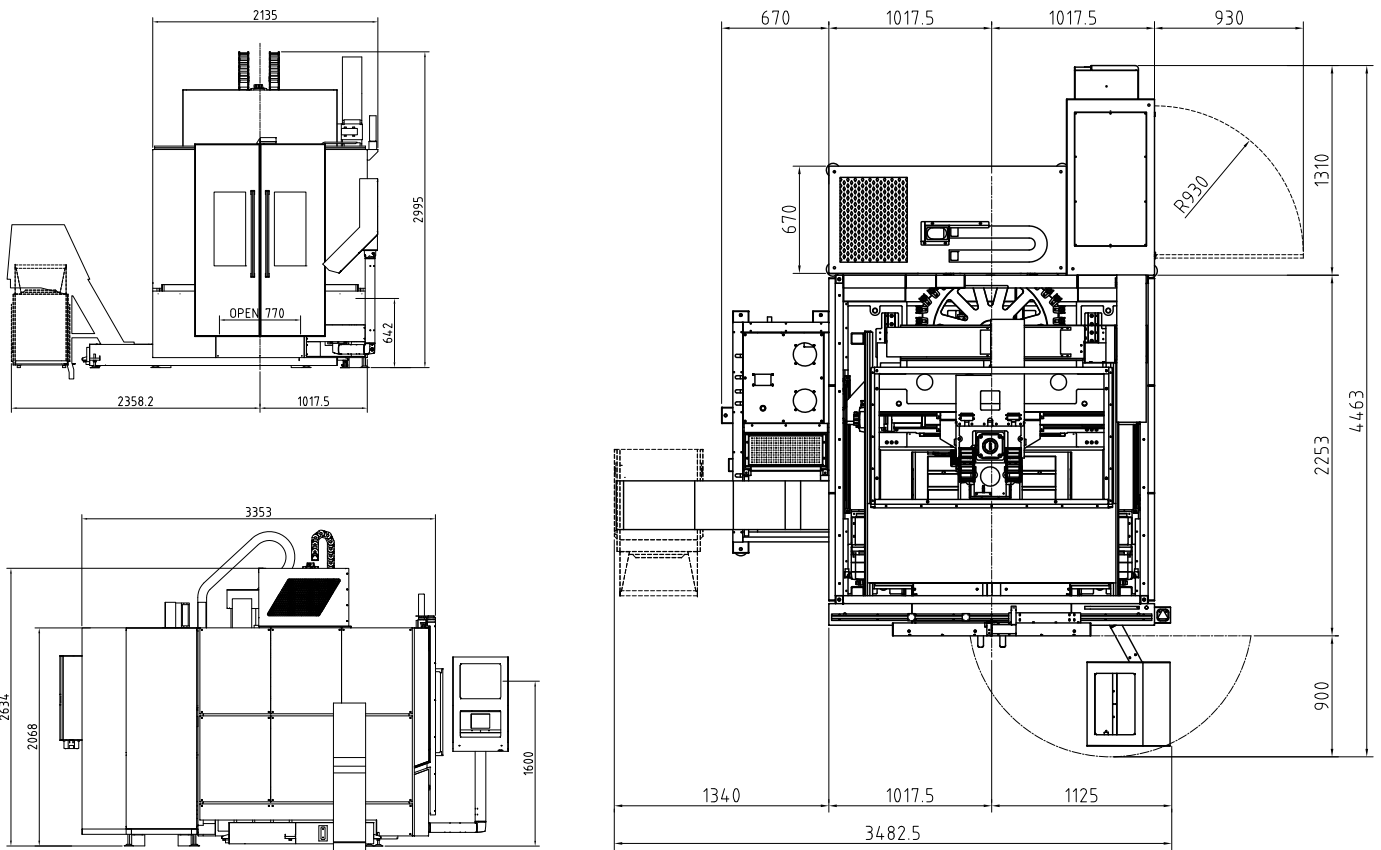

* The above specifications are subject to change without prior notice, no liability for mistakes. Machines may be shown with optional equipment.

U400



- Cross slide design
- One-piece cast iron machine bed ensures maximum stability
- Roller gear cam drive rotary table
- Standard with direct drive spindle 12000 rpm

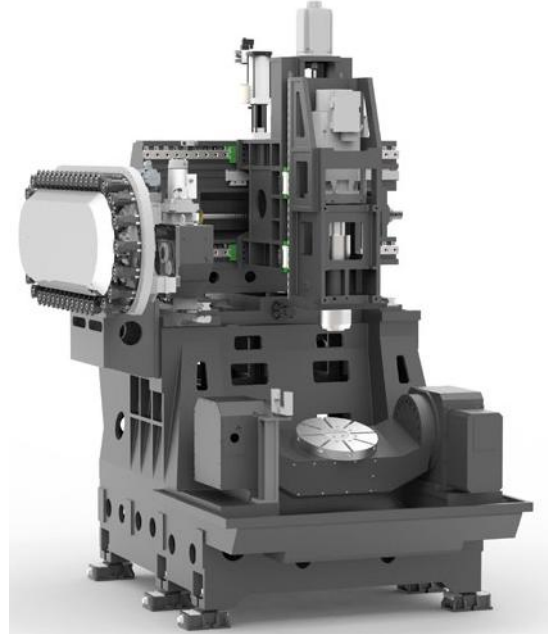

Technical Specifications		U400
CNC Control		
TNC 620/640		5-Axes Simultaneous
828D		4+1
Table		
Max. workpiece diameter	mm	700
Table size	mm	Φ400
T-slot (width x number)	mm	14 x 8
Max. load	kg	255
Travel		
X/Y/Z Travel	mm	700 / 550 / 500
A/C Travel	deg	+30° ~ -120° / 360°
Spindle nose to table	mm	120 - 620
Spindle		
Spindle taper	-	SK40/BBT40/CAT40
Spindle motor power	kW	9 / 22
Spindle motor torque	Nm	63 / 135
Spindle speed	rpm	12000
Feed		
Rapid feed X/Y/Z	m/min	48
Rotation speed A/C	rpm	50/60
Cutting speed	mm/min	1-12000
Tool changer		
Number of tools	pcs	40
Max. tool length	mm	300
Max. tool diameter	mm	Φ80 / Φ125
Max. tool weight	kg	8
Accuracy(VDI 3441 Full travel)		
Positioning accuracy (Without linear scales)	mm	0.008 (X/Y/Z)
Repeatability accuracy (Without linear scales)	mm	0.006 (X/Y/Z)
Positioning accuracy (With linear scales)	mm	0.006 (X/Y/Z)
Repeatability accuracy (With linear scales)	mm	0.004 (X/Y/Z)
Dimensions & Weight		
Dimensions	mm	3640x3430x3250
Weight	kg	7000

Standard configuration

- ✓ Roller gear cam drive rotary table
- ✓ Full enclosed splash guard
- ✓ Direct drive spindle 12000rpm
- ✓ 40 pockets chain type tool changer
- ✓ Chain type chip conveyor
- ✓ Spindle oil cooler
- ✓ Air-conditioned electrical cabinet
- ✓ Rigid tapping
- ✓ Ethernet, CF card and USB interface
- ✓ Automatic lubrication system
- ✓ Coolant system
- ✓ Air blast during cutting
- ✓ LED working lamp
- ✓ End of program light
- ✓ Electrical handwheel (MGP)
- ✓ Tool box
- ✓ Leveling bolts and blocks
- ✓ Coolant gun
- ✓ Air gun
- ✓ User manual

Optional configuration

- Direct drive spindle 15000rpm
- Bult-in spindle 20000rpm HSK A63, 20/24kW_35/42Nm
- Linear scales on X/Y/Z axis
- Rotary encoder on A/C axis
- CTS Coolant Through Spindle + ATS
- Workpiece probe
- Tool probe
- Oil mist collector
- Oil skimmer
- Extra 200GB SSD program memory

* The above specifications are subject to change without prior notice, no liability for mistakes. Machines may be shown with optional equipment.

Cutting Area

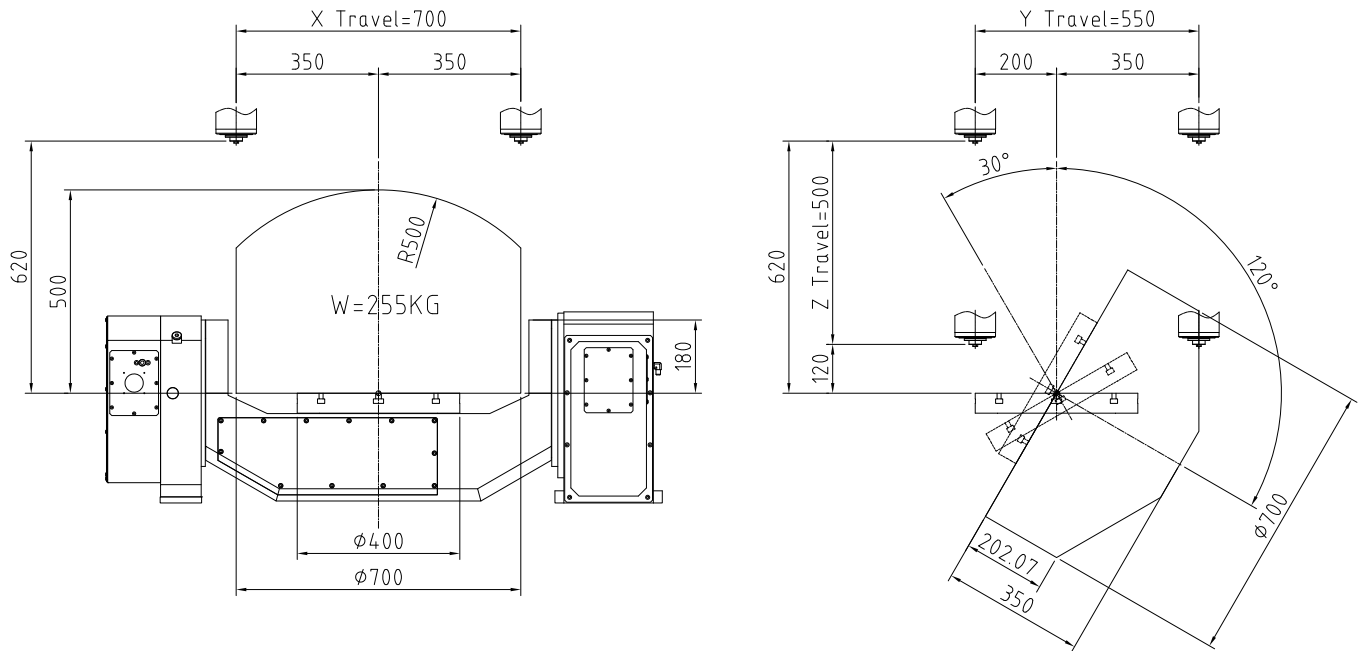

Workpiece samples



* The above specifications are subject to change without prior notice, no liability for mistakes. Machines may be shown with optional equipment.

GT18-5X · GT320-5X · GT428-5X



Technical Specifications		GT18-5X	GT320-5X	GT428-5X
Table				
Table size	mm	1800 x 1400	3300 x 1700	4000x2400
T-slot (width x number x distance)	mm	22 x 7 x 170	22 x 9 x 170	28x11x200
Max. load	kg	6000	10000	12000
A(B)/C Axis	-	±108° / ±270°		±115° / ±360°
Travel				
X/Y/Z Travel	mm	1900/1400/800	3300/2700/1000	4200/3300/1200
Spindle nose to table	mm	100 - 900	100 - 1100	200-1400
90° spindle center line to table	mm	410-1210	410-1410	460-1660
Distance between columns	mm	1960	2000	2800
Spindle				
Spindle taper	-	HSK A63		HSK A100
Motor power	kW	42/56.7		50/61
Motor torque	Nm	68/90.2		160/193
Spindle speed	rpm	24000		12000
Feed				
Rapid feed X/Y/Z	m/min	30	24/24/30	20
Cutting speed	mm/min	1-12000		
A(B)/C Max. speed	rpm	50		
Tool changer				
Number of tools	pcs	60		
Max. tool length	mm	300		400
Max. tool diameter	mm	Φ78 / Φ150		Φ125 / Φ250
Max. tool weight	kg	8		16
Accuracy (VDI 3441 Full travel)				
Positioning accuracy	mm	0.010/0.010/0.008 (X/Y/Z) 6/8 arc-sec (B/C)	0.015/0.015/0.010 (X/Y/Z) 6/8 arc-sec (A/C)	0.020/0.015/0.010 (X/Y/Z) 6/8 arc-sec (A/C)
Repeatability accuracy	mm	0.006 (X/Y/Z) 3/4 arc-sec (B/C)	0.010/0.010/0.006 (X/Y/Z) 3/4 arc-sec (A/C)	0.015/0.010/0.006 (X/Y/Z) 3/4 arc-sec (A/C)
Dimensions & Weight				
Dimensions	mm	6160x4970x4840	10000x5700x5800	10250x6320x6250
Weight	kg	24000	30000	52000

Standard configuration

- ✓ Direct drive A(B)/C head
- ✓ Full enclosed splash guard
- ✓ Chip conveyor (two screw type and one chain type)
- ✓ Air-conditioned electrical cabinet
- ✓ High precision spindle water cooler
- ✓ Linear scales on X/Y/Z axis
- ✓ Rotary encoder on A(B)/C axis
- ✓ Rigid tapping
- ✓ Ethernet, CF card and USB interface
- ✓ Automatic lubrication system
- ✓ Coolant system
- ✓ Air blast during cutting
- ✓ LED working lamp
- ✓ End of program light
- ✓ Electronic handwheel (MPG)
- ✓ Tool box
- ✓ Leveling bolts and blocks
- ✓ Coolant gun
- ✓ Air gun
- ✓ User Manual

Optional configuration

- Built-in spindle HSK A100 15000 rpm
_40/50kW_103/129Nm, 40 pockets tool changer
(GT18-5X/GT320-5X)
- Built-in spindle HSK A100 12000 rpm
_40/47kW_248/293Nm (GT428-5X)
- CTS Coolant through spindle + ATS
- Oil cooling through ballscrew (only available on
GT18-5X)
- Oil skimmer
- Coolant Cooling system
- Workpiece probe
- Tool probe
- Dynamic Collision Monitoring (DCM)
- Kinematics
- Extra 200GB SSD program memory

* The above specifications are subject to change without prior notice, no liability for mistakes. Machines may be shown with optional equipment.



- High speed and high precision machining, widely applied for big die & mold, electronics, defense, aerospace and medical industry
- Dual drive on Y axis to ensure the best dynamic performance (GT18-5X)
- Torque motor direct drive double arm A(B)/C head
- Heidenhain linear scales on X, Y, Z axis

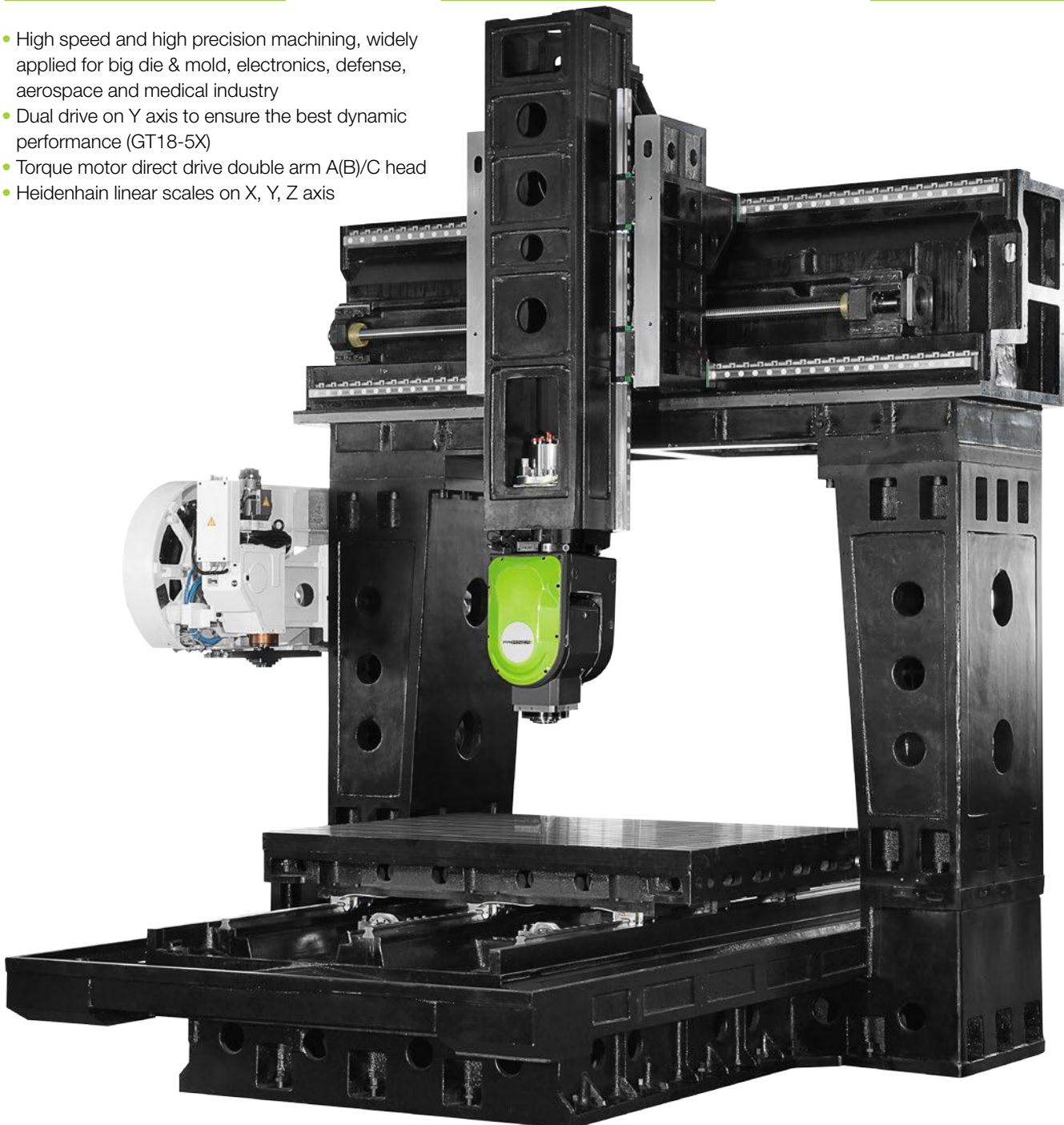

* The above specifications are subject to change without prior notice, no liability for mistakes. Machines may be shown with optional equipment.

GT7



- Best Choice for high speed cutting
- Gantry design with fixed worktable
- Dual drive system with two ballscrews on Y axis to ensure the best dynamic.
- Compact design with mini. floor plan area
- Built-in spindle 36000 rpm, HSK E50
- Optional with graphite machining preparation

Technical Specifications		GT7		
Table				
Table size	mm	800 × 600		
T-slot (width x number x distance)	mm	18 × 5 × 100		
Max. load	kg	600		
Travel				
X/Y/Z Travel	mm	700 / 600 / 450		
Distance between columns	mm	-		
Spindle				
Spindle taper	-	HSK A63	HSK E50	HSK E32
Spindle motor power	kW	20 / 24	15 / 18	6.3 / 9.45
Spindle motor torque	Nm	35 / 42	14 / 17.3	2 / 3
Spindle speed	rpm	20000	36000	40000
Spindle nose to table	mm	135-585	135-585	145-595
Feed				
Rapid feed X/Y/Z	m/min	15		
Cutting speed	mm/min	1-12000		
Tool changer				
Number of tools	pcs	32		
Max. tool length	mm	250		
Max. tool diameter	mm	63		
Max. tool weight	kg	4		
Accuracy (VDI 3441 Full travel)				
Positioning accuracy	mm	0.006		
Repeatability accuracy	mm	0.003		
Dimensions & Weight				
Dimensions	mm	3560×3380×2995		
Weight	kg	8000		

Standard configuration

- ✓ Full enclosed splash guard
- ✓ Built-in motor spindle HSK E50 36000 rpm
- ✓ 32 pockets tool changer
- ✓ Chain type chip conveyor
- ✓ Air-conditioned electrical cabinet
- ✓ High precision spindle water cooler
- ✓ Linear scales on X/Y/Z axis
- ✓ Rigid tapping
- ✓ Ethernet, CF card and USB interface
- ✓ Centralized automatic grease lubrication system
- ✓ Coolant system
- ✓ Air blast during cutting
- ✓ LED working lamp
- ✓ End of program light
- ✓ Electronic handwheel (MPG)
- ✓ Tool box
- ✓ Leveling bolts and blocks
- ✓ Coolant gun
- ✓ Air gun
- ✓ User Manual

Optional configuration

- Built-in spindle HSK A63 20000rpm, 32 pockets tool changer
- Built-in spindle HSK E32 40000rpm, 48 pockets tool changer
- Graphite Machining Preparation
- Oil mist collector
- Oil cooling through ballscrew
- CTS Coolant through spindle + ATS
- Oil skimmer
- Minimum Quantity Lubrication system
- Coolant Cooling system
- Workpiece probe
- Tool probe
- Extra 200GB SSD program memory

Worktable

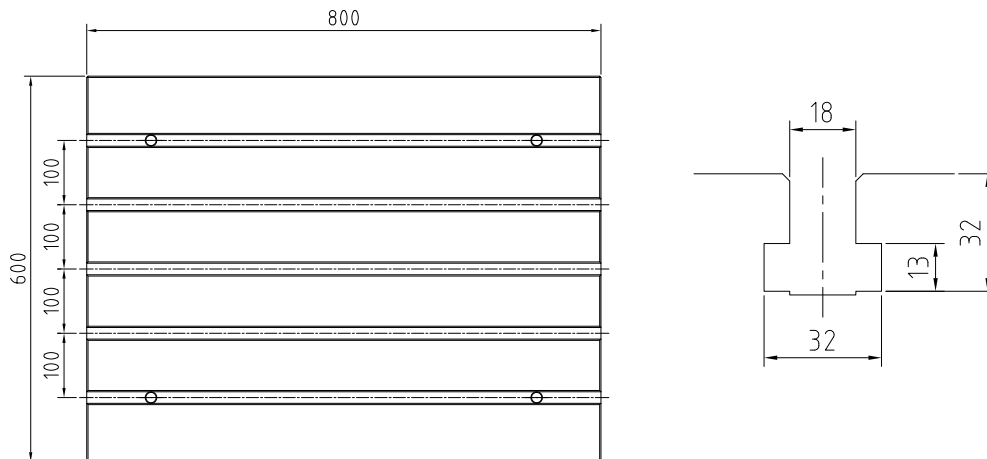

Dimensions

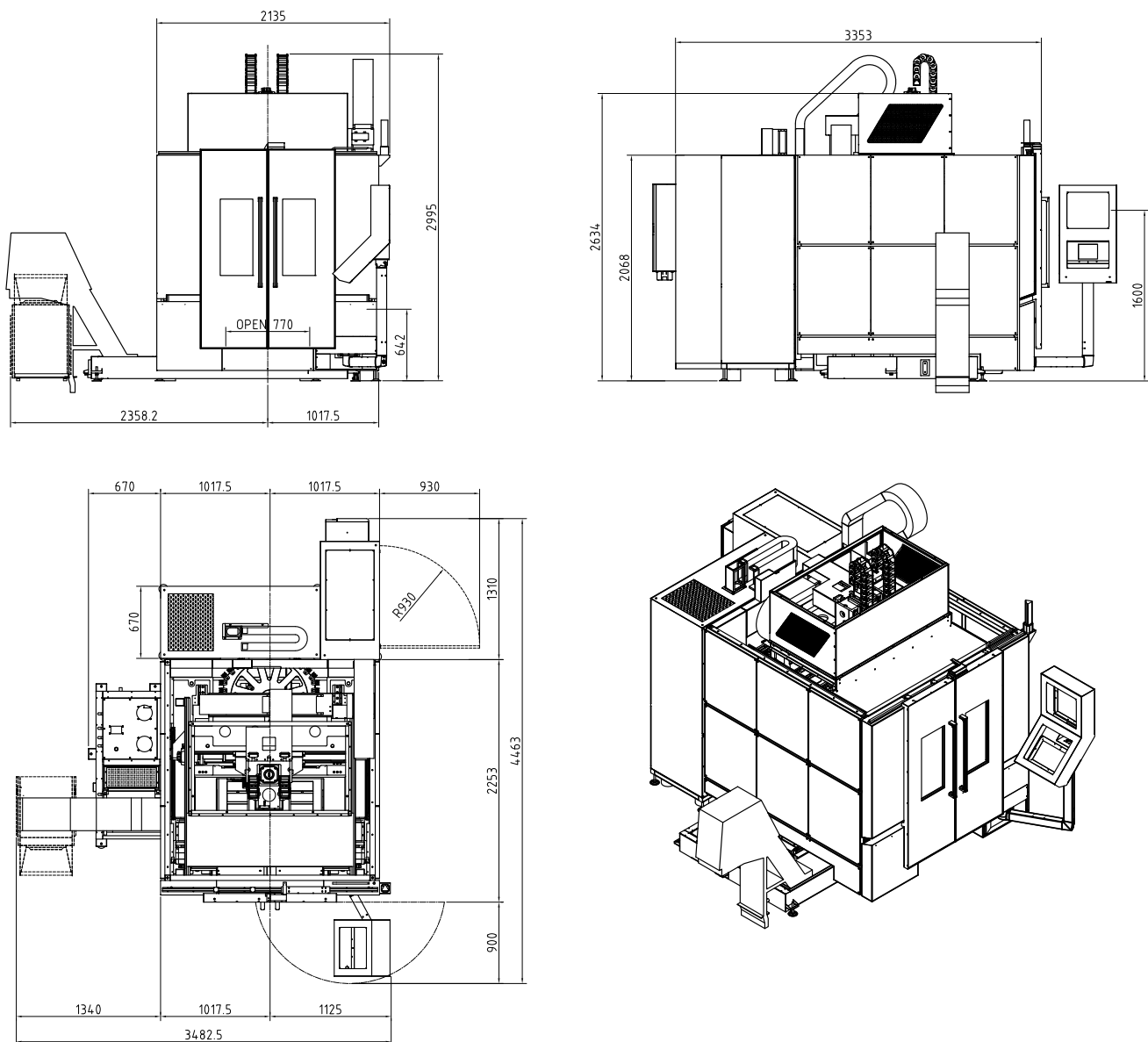

* The above specifications are subject to change without prior notice, no liability for mistakes. Machines may be shown with optional equipment.

GT11



Technical Specifications		GT11
Table		
Table size	mm	1200x700
T-slot (width x number x distance)	mm	18x6x100
Max. load	kg	1500
Travel		
X/Y/Z Travel	mm	1150 / 700 / 520
Spindle nose to table	mm	140-660
Spindle		
Spindle taper		HSK A63
Motor power	kW	25/28
Motor torque	Nm	87/96
Spindle speed	rpm	20000
Feed		
Rapid feed X/Y/Z	m/min	24
Cutting speed	mm/min	1-12000
Tool changer		
Number of tools	pcs	40
Max. tool length	mm	300
Max. tool diameter	mm	Φ78 / Φ125
Max. tool weight	kg	8
Accuracy (VDI3441 Full travel)		
Positioning accuracy	mm	0.006
Repeatability accuracy	mm	0.003
Dimensions & Weight		
Dimensions	mm	3680x3180x3090
Weight	kg	9000

* The above specifications are subject to change without prior notice, no liability for mistakes. Machines may be shown with optional equipment.

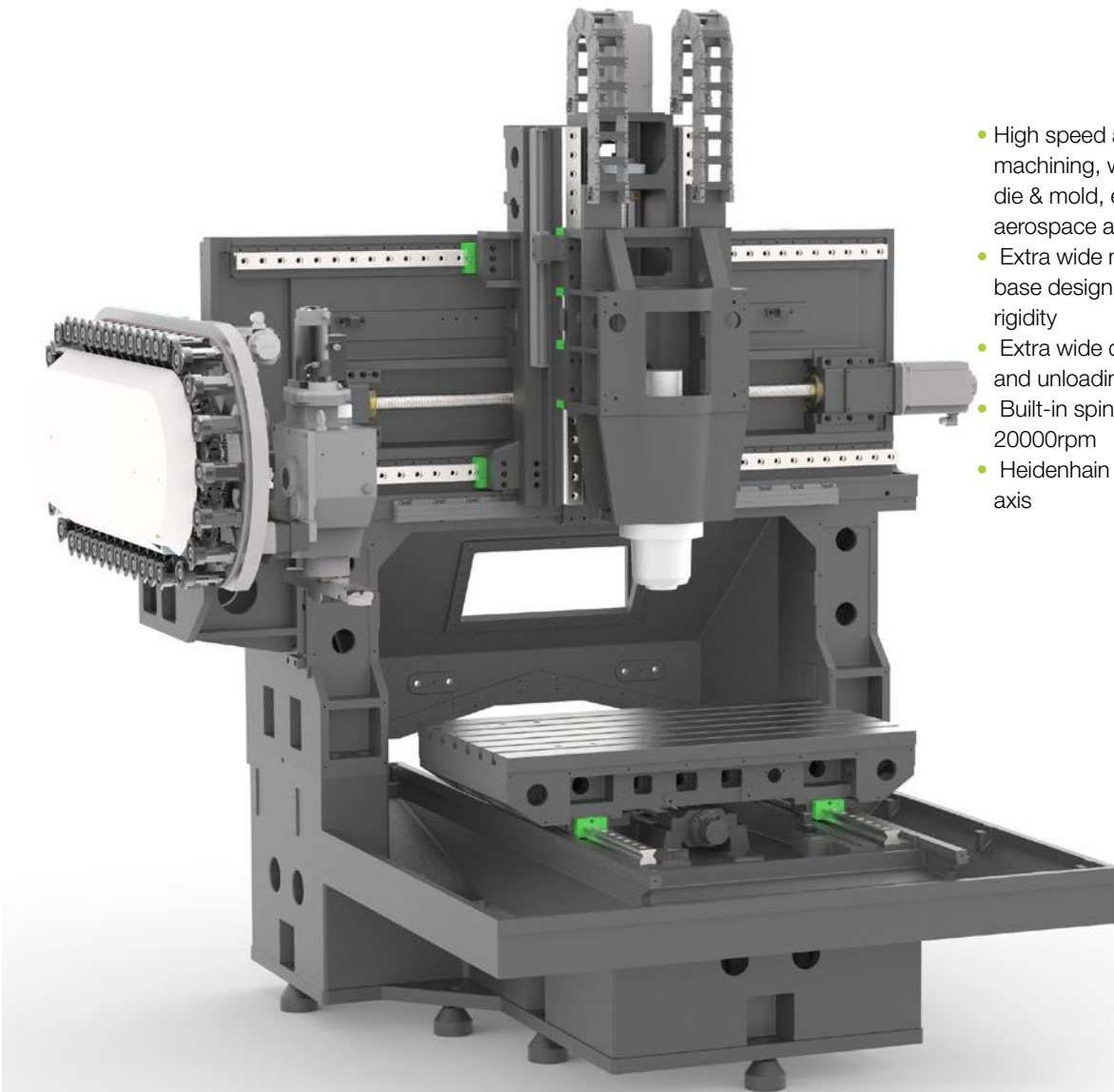

- High speed and high precision machining, widely applied for big die & mold, electronics, defense, aerospace and medical industry
- Extra wide machine column and base design ensures the high rigidity
- Extra wide door for easy loading and unloading
- Built-in spindle HSK A63 20000rpm
- Heidenhain linear scales on X/Y/Z axis



Standard configuration

- ✓ Full enclosed splash guard
- ✓ Built-in spindle HSK A63 20000 rpm
- ✓ 40 pockets chain type tool changer
- ✓ Two screw type and one chain type chip conveyor
- ✓ Air-conditioned electrical cabinet
- ✓ High precision spindle water cooler
- ✓ Linear scales on X/Y/Z
- ✓ Rigid tapping
- ✓ Ethernet, CF card and USB interface
- ✓ Automatic lubrication system
- ✓ Coolant system
- ✓ Air blast during cutting
- ✓ LED working lamp
- ✓ End of program light
- ✓ Electronic handwheel (MPG)
- ✓ Tool box
- ✓ Leveling bolts and blocks
- ✓ Coolant gun
- ✓ Air gun
- ✓ User Manual

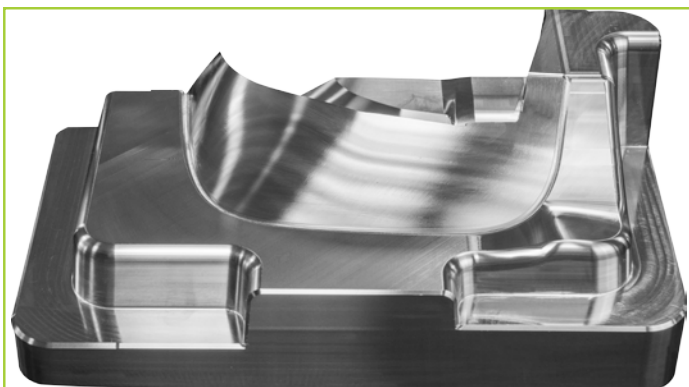

Optional configuration

- CTS Coolant through spindle + ATS
- Oil cooling through ballscrew
- Oil skimmer
- Oil mist collector
- Workpiece probe
- Tool probe
- Extra 200GB SSD program memory

* The above specifications are subject to change without prior notice, no liability for mistakes. Machines may be shown with optional equipment.

GT18



Technical Specifications		GT18
Table		
Table size	mm	1800×1400
T-slot (width x number x distance)	mm	22×7×170
Max. load	kg	6000
Travel		
X/Y/Z Travel	mm	1800 / 1400 / 800
Spindle nose to table	mm	150-950
Spindle center to column	mm	400
Distance between columns	mm	1960
Spindle		
Spindle taper		HSK A63
Motor power	kW	21 / 27
Motor torque	Nm	85 / 116
Spindle speed	rpm	24000
Feed		
Rapid feed X/Y/Z	m/min	30
Cutting speed	mm/min	1-12000
Tool changer		
Number of tools	pcs	60
Max. tool length	mm	300
Max. tool diameter	mm	Φ78 / Φ150
Max. tool weight	kg	8
Accuracy (VDI3441 Full travel)		
Positioning accuracy	mm	0.010/0.010/0.008 (X/Y/Z)
Repeatability accuracy	mm	0.006 (X/Y/Z)
Dimensions & Weight		
Dimensions	mm	6100×4965×4380
Weight	kg	22000

* The above specifications are subject to change without prior notice, no liability for mistakes. Machines may be shown with optional equipment.

- High speed and high precision machining, widely applied for big die & mold, electronics, defense, aerospace and medical industry
- Extra wide machine column and base design ensures the high rigidity
- Dual drive system with two ballscrews and three linear guideways on Y axis to ensure high accuracy of machining
- Extra wide door for easy loading and unloading
- Built-in spindle HSK A63 24000rpm
- Oil cooling through ballscrew
- Heidenhain linear scales on three axes
- 60 pockets chain type servo tool changer

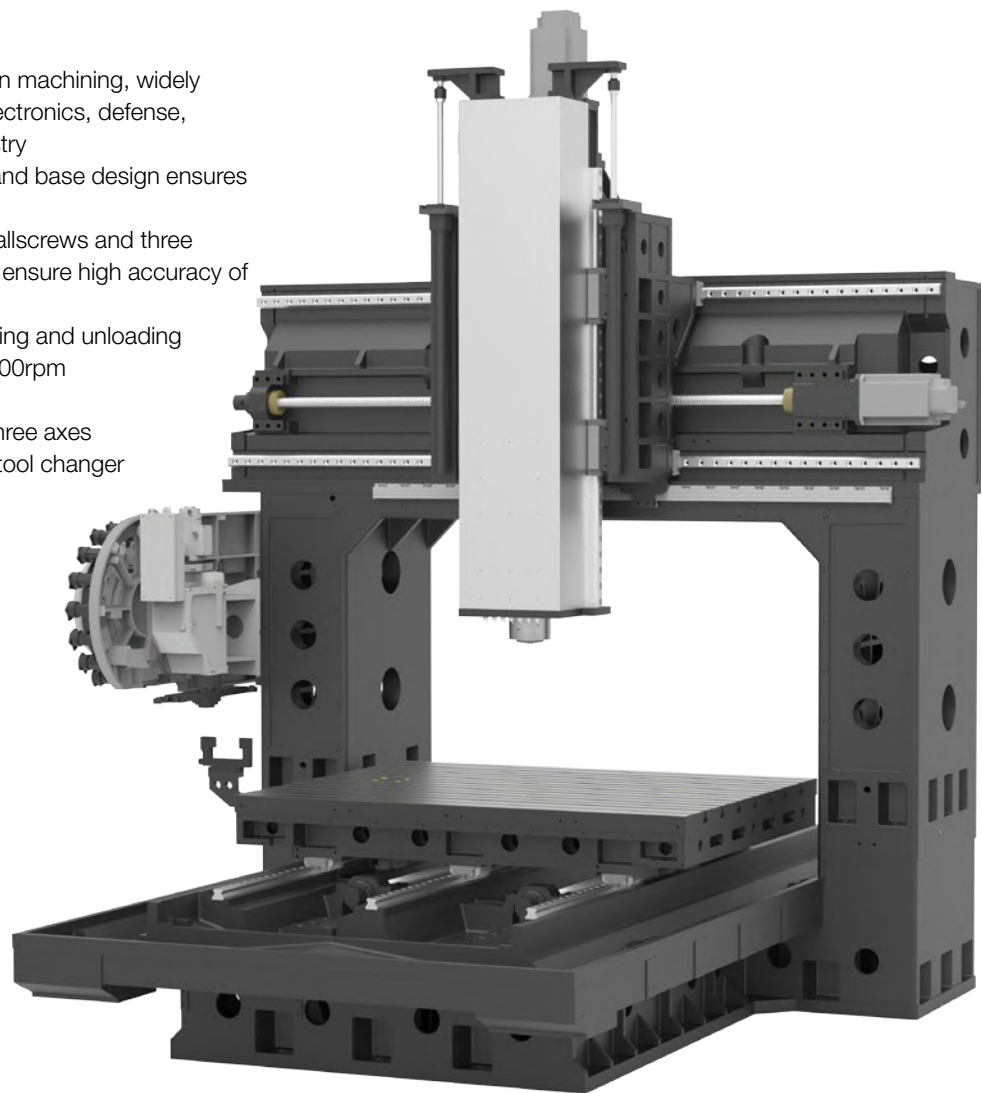

Standard configuration

- ✓ Full enclosed splash guard
- ✓ Built-in spindle HSK A63 24000 rpm
- ✓ 60 pockets chain type servo tool changer
- ✓ Two screw type and one chain type chip conveyor
- ✓ Air-conditioned electrical cabinet
- ✓ High precision spindle water cooler
- ✓ Linear scales on X/Y/Z
- ✓ Oil-air lubrication system for spindle
- ✓ Rigid tapping
- ✓ Ethernet, CF card and USB interface
- ✓ Automatic lubrication system
- ✓ Coolant system
- ✓ Air blast during cutting
- ✓ LED working lamp
- ✓ End of program light
- ✓ Electronic handwheel (MPG)
- ✓ Tool box
- ✓ Leveling bolts and blocks
- ✓ Coolant gun
- ✓ Air gun
- ✓ User Manual

Optional configuration

- Built-in spindle HSK A100 12000 rpm
- CTS Coolant through spindle + ATS
- Oil cooling through ballscrew
- Oil skimmer
- Oil mist collector
- Workpiece probe
- Tool probe
- Extra 200GB SSD program memory

* The above specifications are subject to change without prior notice, no liability for mistakes. Machines may be shown with optional equipment.

UHP Center VF900 · 1100 · 1300 · 1500



- VF series ultra high performance center is specially designed for high speed and high efficiency machining applications
- Advanced design with reinforced body structure through FEM analysis. VF series offers superb cutting performance and reduced vibration to meet the highest machining demands
- Extra wide machine column and base design ensures the high rigidity during high speed movement
- Motor seat cooling circuit (VF1100 , VF1300 , VF1500)
- Linear scales (optional)

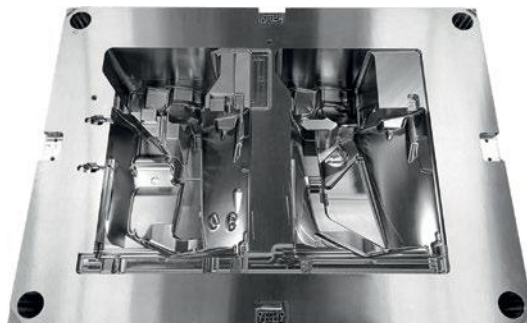

Standard configuration

- ✓ Fully enclosed splash guard
- ✓ Direct drive spindle 12000 rpm (VF900)
- ✓ Direct drive spindle 15000 rpm (VF1100, VF1300, VF1500)
- ✓ 24 pockets arm tool changer
- ✓ Two screw type and one chain type chip conveyor (VF 1100, VF1300)
- ✓ Chain type chip conveyor (VF900, VF1500)
- ✓ Spindle oil cooler
- ✓ Air-conditioned electrical cabinet
- ✓ Motor seat cooling circuit (VF1100, VF1300, VF1500)
- ✓ Rigid tapping
- ✓ Ethernet, CF card and USB interface
- ✓ Automatic lubrication system
- ✓ Coolant system
- ✓ LED working lamp
- ✓ End of program light
- ✓ Electronic handwheel (MPG)
- ✓ Tool box
- ✓ Leveling bolts and blocks
- ✓ Coolant gun
- ✓ Air gun
- ✓ Air blast during cutting
- ✓ User Manual

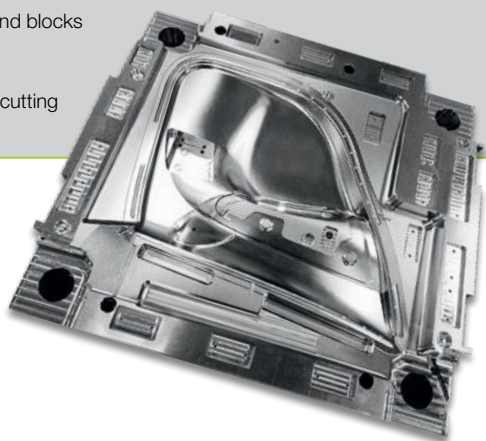

Optional configuration

- Built-in spindle HSK A63 20000rpm
- 28 pockets arm tool changer
- 40 pockets chain type tool changer(VF1100, VF1300, VF1500)
- CTS coolant through spindle + ATS
- Oil cooling through ballscrew (Only available on VF1100)
- Oil skimmer
- Linear scales on X/Y/Z axis
- 4th axis
- 4/5th axis
- Workpiece probe
- Tool probe
- Extra 200GB SSD program memory (Only available on SIEMENS Control)

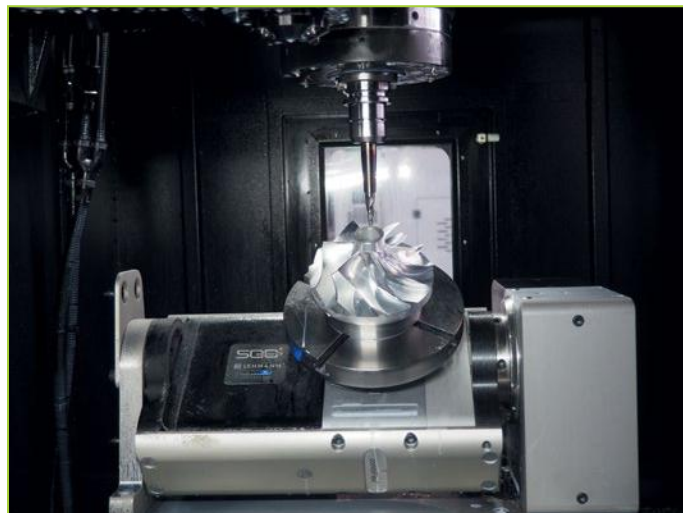

Lehmann 4th & 5th axis

* The above specifications are subject to change without prior notice, no liability for mistakes. Machines may be shown with optional equipment.



Cast iron tempered for stress relief to ensure structural stability without deformation

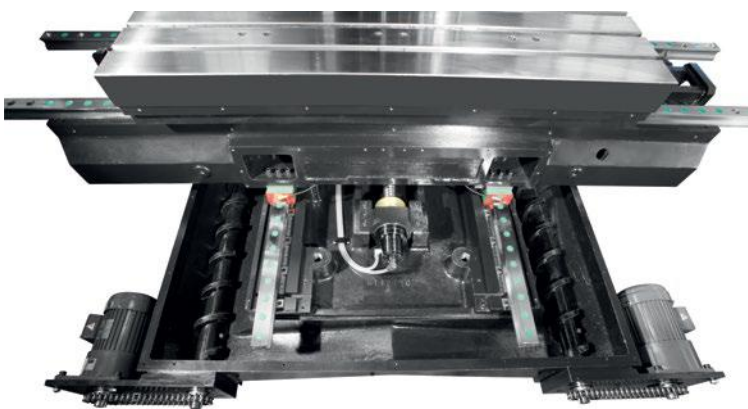

Two screw type chip conveyors in Y-axis (VF1100 & VF1300)



External tool cooling



High rigidity spindle

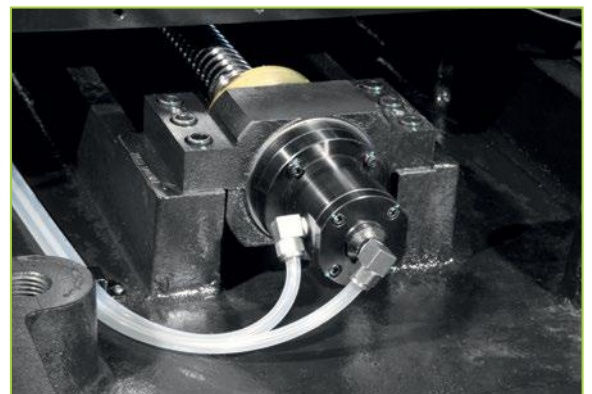

Oil cooling through ballscrew (VF1100)

* The above specifications are subject to change without prior notice, no liability for mistakes. Machines may be shown with optional equipment.

Worktable (VF1100)

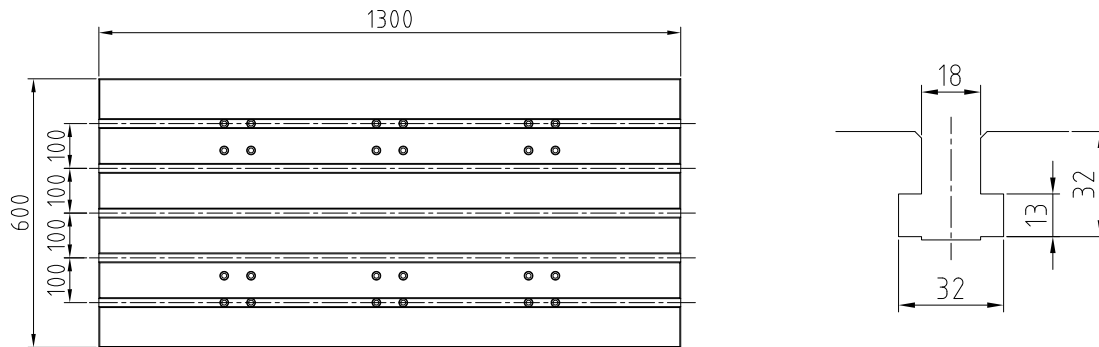

Dimensions (VF1100)

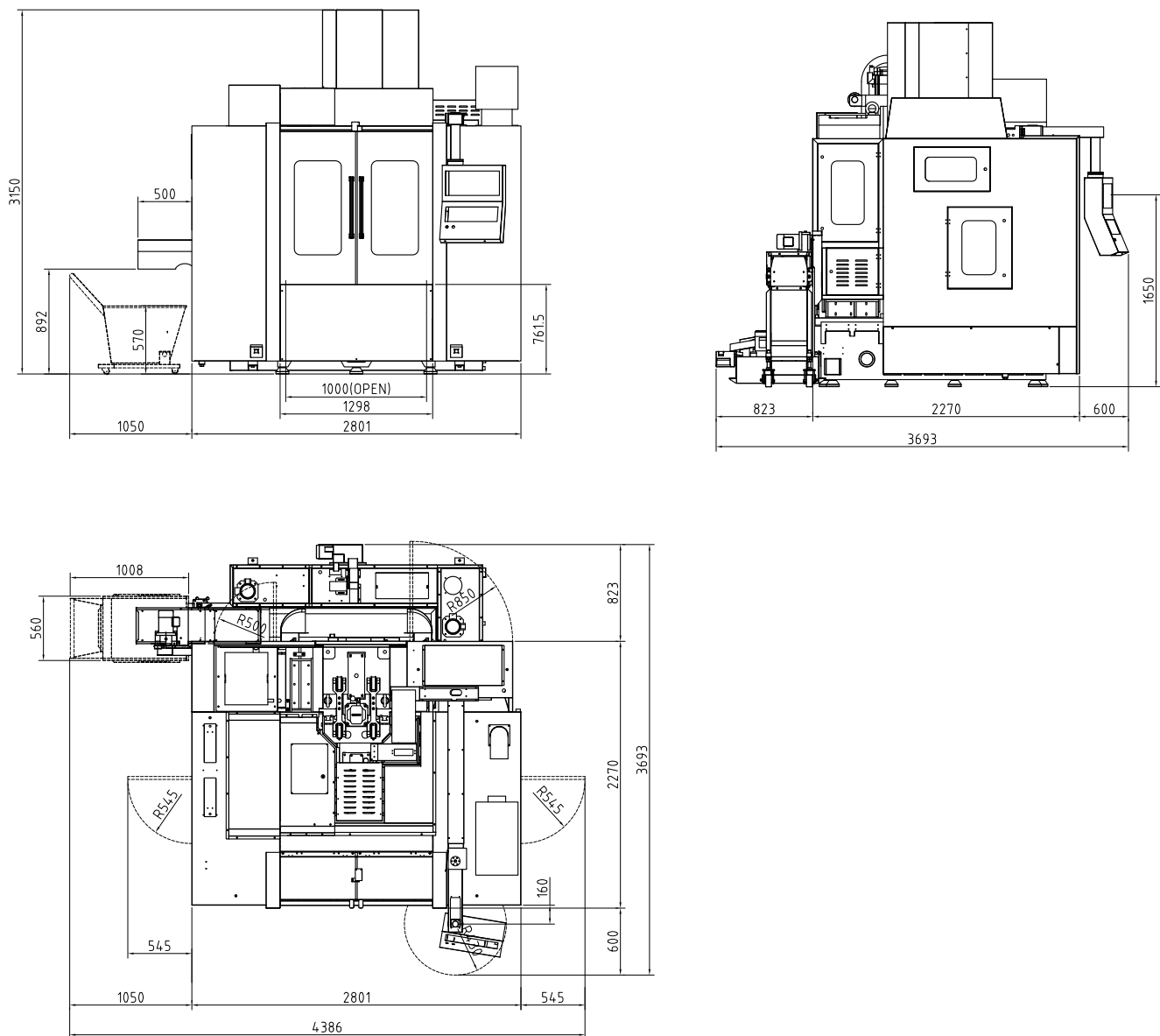

Technical Specifications

Technical Specifications		VF900	VF1100	VF1300	VF1500
Table					
Table size	mm	1060 x 600	1300 x 600	1500 x 650	1700 x 700
T-slot (width x number x distance)	mm	18 x 5 x 100		18 x 6 x 100	
Max. load	kg	800	1000	1200	1500
Travel					
X/Y/Z Travel	mm	900 / 600 / 600	1100 / 650 / 600	1300 / 650 / 600	1500/760/700
Spindle nose to table	mm	150 - 750		130 - 830	
Spindle center to column	mm	652	697		802
Spindle					
Spindle taper	-	SK40 / BBT40 / CAT 40			
Motor power/torque	-	9/22kW; 63/135Nm (SIEMENS) 11/18.5kW; 52.5/118Nm (FANUC)	20/53kW; 126/250Nm (SIEMENS) 15/30kW; 95.5/191Nm (FANUC)		
Spindle speed	rpm	12000	15000 Siemens, 12000 Fanuc		
Spindle(option)	-	HSK A63, 20000rpm		HSK A63, 20000rpm	
Motor power/torque	-	20/24kW; 35/42Nm		25/28kW; 87/96Nm	
Feed					
Rapid feed X/Y/Z	m/min	36			24
Cutting feed	mm/min	1 - 12000			
Tool changer					
Number of tools	pcs	24			
Max. tool length	mm	300			
Max. tool diameter	mm	Φ78 / Φ125			
Max. tool weight	kg	8			
Accuracy (VDI 3441 Full travel)					
Positioning accuracy (without linear scales)	mm	0.008		0.010	
Positioning repeatability (without linear scales)	mm	0.006		0.006	
Positioning accuracy (with linear scales)	mm	0.006		0.008	
Positioning repeatability (with linear scales)	mm	0.004		0.006	
Dimensions & Weight					
Dimensions	mm	3850x2340x3000	3850x3100x3185	4025x3090x3185	5180x2365x3170
Weight	kg	6500	7500	8000	10000



Cooling unit with chip conveyor



Keyarrow telescopic covers in all axes

* The above specifications are subject to change without prior notice, no liability for mistakes. Machines may be shown with optional equipment.

UHP Center VF760



- Cast iron is tempered for stress relief to ensure structural stability without deformation
- C3 class ballscrews ensures the highest accuracy and durability
- Pre-tension on all axis minimizes thermal distortion



Standard configuration

- ✓ Fully enclosed splash guard
- ✓ Direct drive spindle 12000 rpm
- ✓ 24 pockets arm tool changer
- ✓ Chain type chip conveyor
- ✓ Spindle oil cooler
- ✓ Air-conditioned electrical cabinet
- ✓ Rigid tapping
- ✓ Ethernet, CF card and USB interface
- ✓ Automatic lubrication system
- ✓ Coolant system
- ✓ LED working lamp
- ✓ End of program light
- ✓ Electronic handwheel (MPG)
- ✓ Tool box
- ✓ Leveling bolts and blocks
- ✓ Coolant gun
- ✓ Air gun
- ✓ Air blast during cutting
- ✓ User Manual

Optional configuration

- Direct drive spindle 15000 rpm
- Built-in spindle 20000 rpm, HSK A63
- 28 pockets arm tool changer
- CTS coolant through spindle + ATS
- 4th axis
- 4/5th axis
- Workpiece probe
- Tool probe
- Linear scales on X/Y/Z axis
- Oil skimmer
- Extra 200GB SSD program memory (Only available on SIEMENS Control)

Technical Specifications		VF760
Table		
Table size	mm	900 x 420
T-slot (width x number x distance)	mm	14 x 3 x 125
Max. load	kg	500
Travel		
X / Y / Z Travel	mm	720 / 450 / 520
Spindle nose to table	mm	100 - 620
Spindle center to column	mm	517
Spindle		
Spindle taper	-	SK 40 / BBT 40 / CAT 40
Spindle speed	rpm	12000
Motor power/torque	-	9/22kW; 63/135Nm (SIEMENS) 11/18.5kW; 52.5/118Nm (FANUC)
Spindle (option)	-	HSK A63, 20000rpm
Motor power/torque	-	20/24kW; 35/42Nm
Feed		
Rapid feed X/Y/Z	m/min	48 (24 opt.)
Cutting feed	mm/min	1-12000
Tool changer		
Number of tools	pcs	24
Max. tool length	mm	300
Max. tool diameter	mm	Φ78 / Φ125
Max. tool weight	kg	8
Accuracy (VDI 3441 Full travel)		
Positioning accuracy (without linear scales)	mm	0.080
Positioning repeatability (without linear scales)	mm	0.006
Positioning accuracy (with linear scales)	mm	0.006
Positioning repeatability (with linear scales)	mm	0.004
Dimensions & Weight		
Dimensions	mm	3250x2710x2900
Weight	kg	4500

* The above specifications are subject to change without prior notice, no liability for mistakes. Machines may be shown with optional equipment.

Worktable

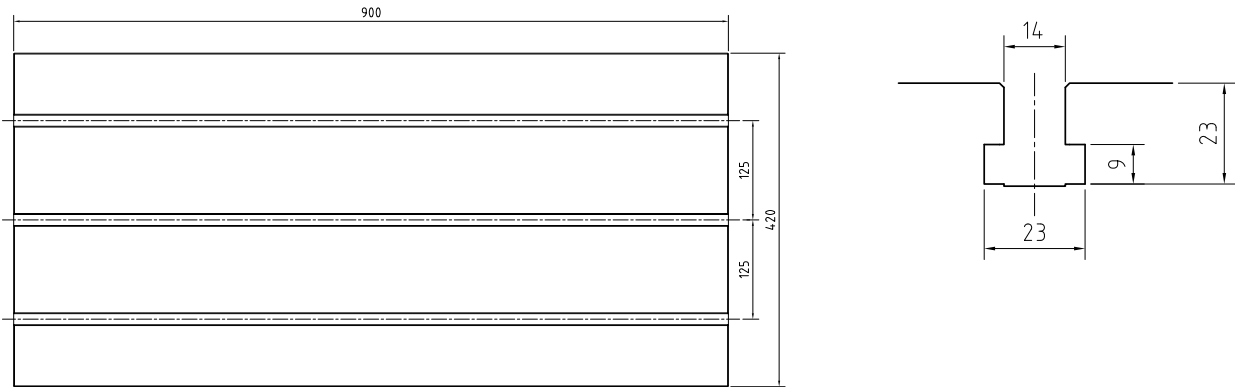

Dimensions

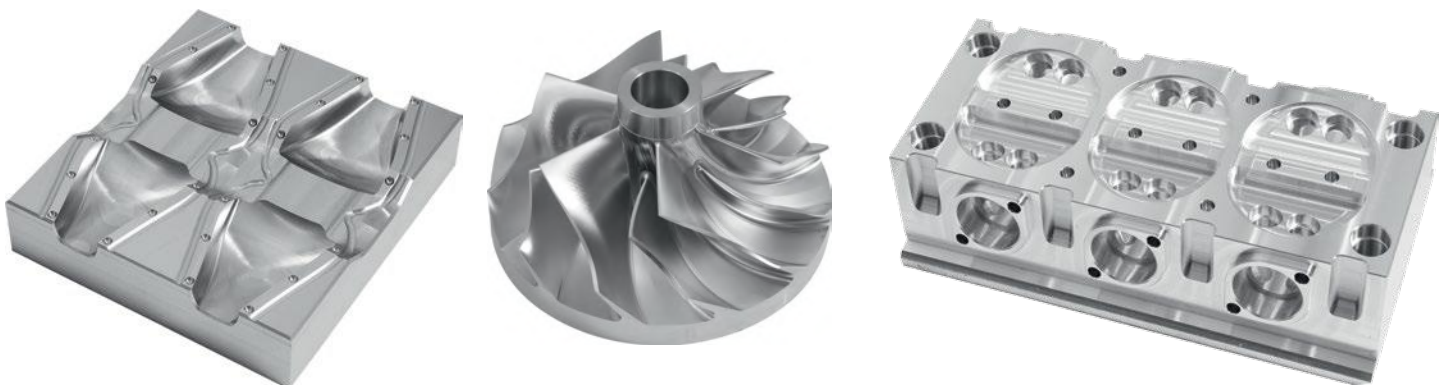
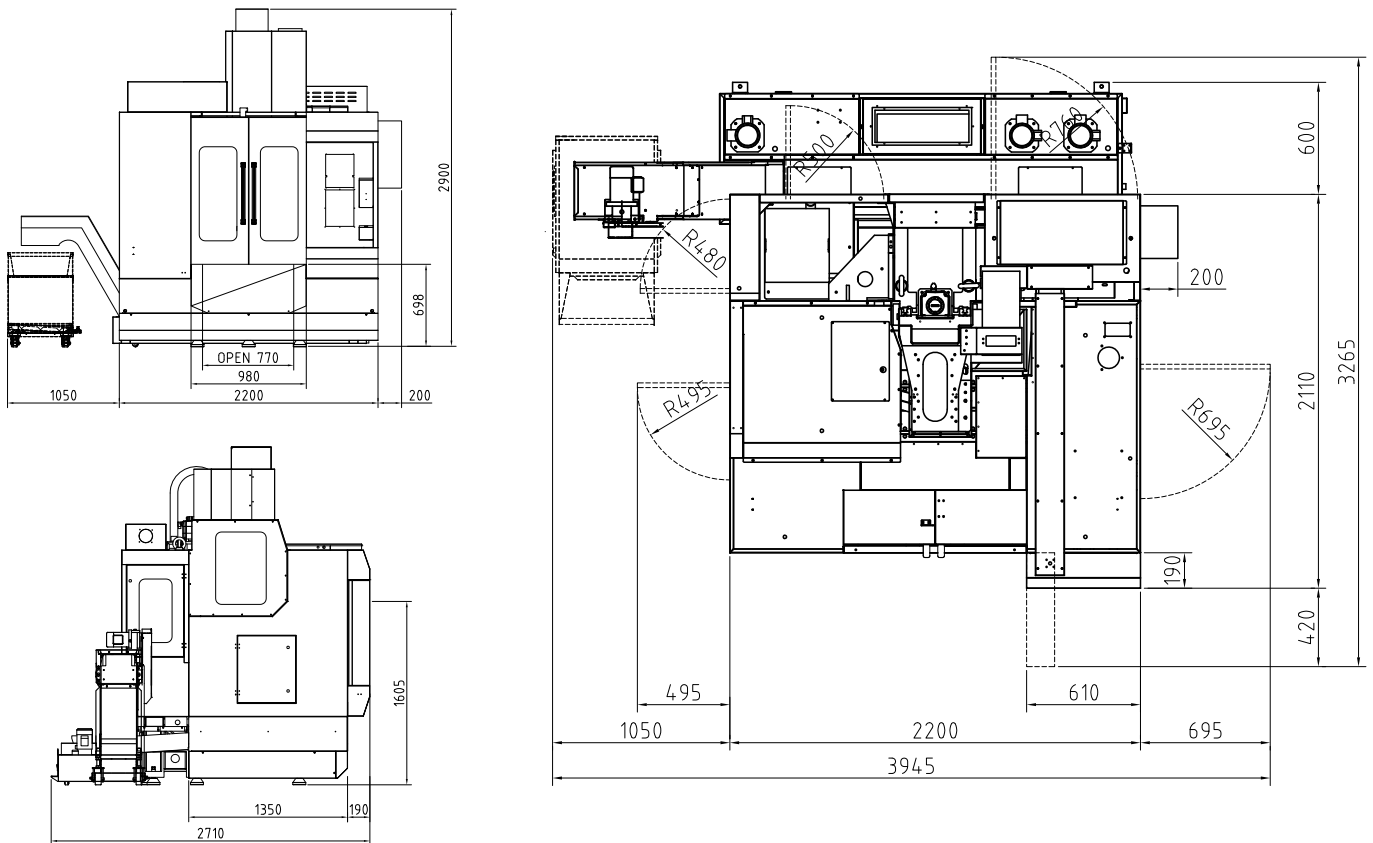

* The above specifications are subject to change without prior notice, no liability for mistakes. Machines may be shown with optional equipment.

MINI Center



- Training
- Tool room workshop
- Metal parts machining
- Model making
- R&D
- Cast iron is tempered for stress relief to ensure machine stability without deformation



Technical Specifications		Mini Center
Table		
Table size	mm	650 x 300
T-slot (width x number x distance)	mm	14 x 3 x 100
Max. load	kg	200
Travel		
X / Y / Z Travel	mm	500 / 300 / 400
Spindle nose to table	mm	120 - 520
Spindle center to column	mm	340
Spindle		
Spindle taper	-	SK 40 / BT 40 / CAT 40
Spindle motor power/torque	-	4.8/19kW; 27/65Nm (SIEMENS) 3.7/13kW; 23.6/82.8Nm (FANUC)
Spindle speed	rpm	10000
Feed		
Rapid speed	m/min	X/Y: 24, Z: 16
Cutting speed	mm/min	1-10000
Tool changer		
Number of tools	pcs	12
Max. tool length	mm	300
Max. tool diameter	mm	Φ90 / Φ125
Max. tool weight	kg	8
Accuracy (VDI 3441 Full travel)		
Positioning accuracy	mm	0.010
Positioning repeatability	mm	0.008
Dimensions & Weight		
Dimensions	mm	1660x2000x2495
Weight	kg	1800

Standard configuration

- ✓ Fully enclosed splash guard
- ✓ Belt drive spindle 10000 rpm
- ✓ 12 position umbrella tool changer
- ✓ Heat exchanger for electrical cabinet
- ✓ Rigid tapping
- ✓ Ethernet, CF card and USB interface
- ✓ Automatic lubrication system
- ✓ Coolant system
- ✓ LED working lamp
- ✓ End of program light
- ✓ Electronic handwheel (MPG)
- ✓ Tool box
- ✓ Leveling bolts and blocks
- ✓ Coolant gun
- ✓ Air gun
- ✓ Chip flushing system
- ✓ User Manual

Optional configuration

- Spindle oil cooler
- Workpiece probe
- Tool probe
- 4th axis
- Oil skimmer



12 position umbrella tool changer

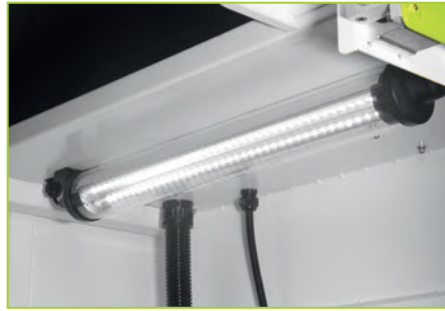

LED Internal lamp



Chip flushing system



4th axis (optional)



Tool probe (optional)



Chip collector & Coolant tank

Worktable

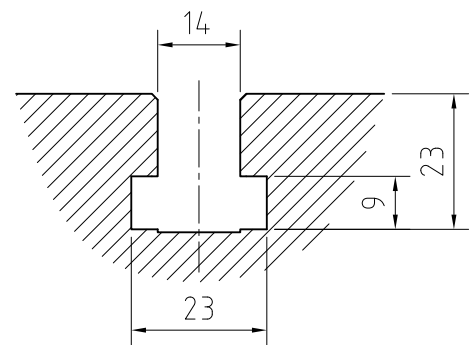
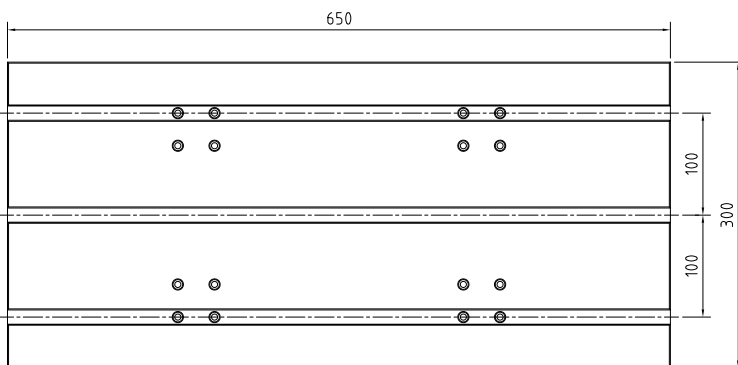

Dimensions

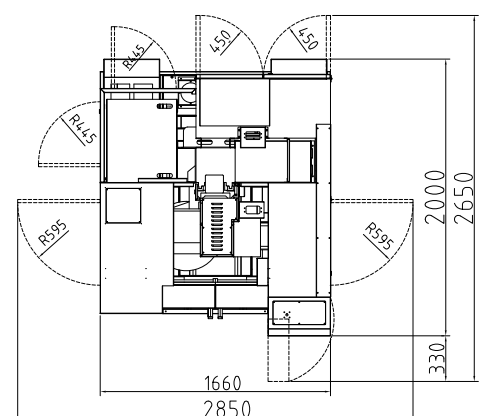
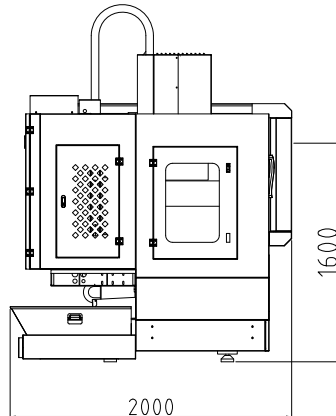
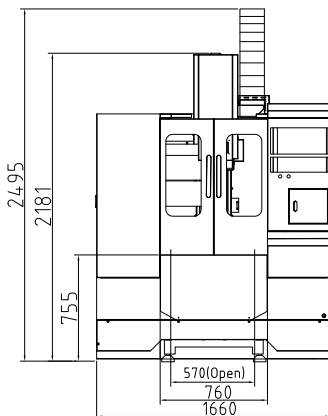

* The above specifications are subject to change without prior notice, no liability for mistakes. Machines may be shown with optional equipment.

Delta Center V7L Lite



- Toolroom workshop
- Metal parts machining
- Model making, R&D
- Cast iron is tempered for stress relief to ensure machine stability without deformation
- C3 class ballscrews ensures the highest accuracy and durability
- Pre-tension on all axes minimizes thermal distortion



Technical Specifications		Delta Center V7L Lite	
Table			
Table size	mm	900 x 420	
T-slot (width x number x distance)	mm	14 x 3 x 125	
Max. load	kg	500	
Travel			
X/Y/Z Travel	mm	760 / 450 / 520	
Spindle nose to table	mm	100 - 620	
Spindle center to column	mm	517	
Spindle			
Spindle taper	-	SK 40 / BT 40 / CAT 40	
Spindle speed	rpm	10000	
Spindle motor power/torque	-	7.5/15kW; 36/72Nm (SIEMENS) 3.7/13kW; 23.6/82.8Nm (FANUC)	
Feed			
Rapid feed X/Y/Z	m/min	30	
Cutting speed	mm/min	1-12000	
Tool changer			
Number of tools	pcs	24	
Max. tool length	mm	300	
Max. tool diameter	mm	Φ78 / Φ125	
Max. tool weight	kg	8	
Accuracy (VDI 3441 Full travel)			
Positioning accuracy	mm	0.008	
Positioning repeatability	mm	0.006	
Dimensions & Weight			
Dimensions	mm	2900x2295x2900	
Weight	kg	4500	

Standard configuration

- ✓ Fully enclosed splash guard
- ✓ Belt drive spindle 10000 rpm
- ✓ 24 pockets arm tool changer
- ✓ Screw type chip conveyor
- ✓ Heat exchanger for electrical cabinet
- ✓ Rigid tapping
- ✓ Ethernet CF card and USB interface
- ✓ Automatic lubrication system
- ✓ Coolant system
- ✓ LED working lamp
- ✓ End of program light
- ✓ Electronic handwheel (MPG)
- ✓ Tool box
- ✓ Leveling bolts and blocks
- ✓ Coolant gun
- ✓ Air gun
- ✓ Chip flushing system
- ✓ User Manual

Optional configuration

- Spindle oil cooler
- CTS Coolant through spindle + ATS
- 4th axis
- Workpiece probe
- Tool probe
- Oil skimmer

* The above specifications are subject to change without prior notice, no liability for mistakes. Machines may be shown with optional equipment.



24 pockets arm tool changer

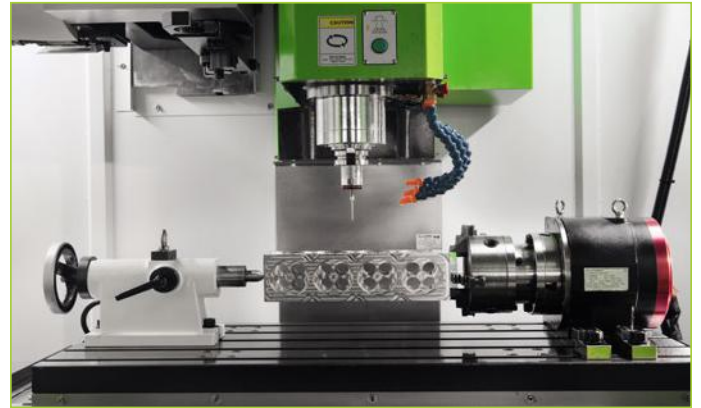

4th axis (optional)

Worktable

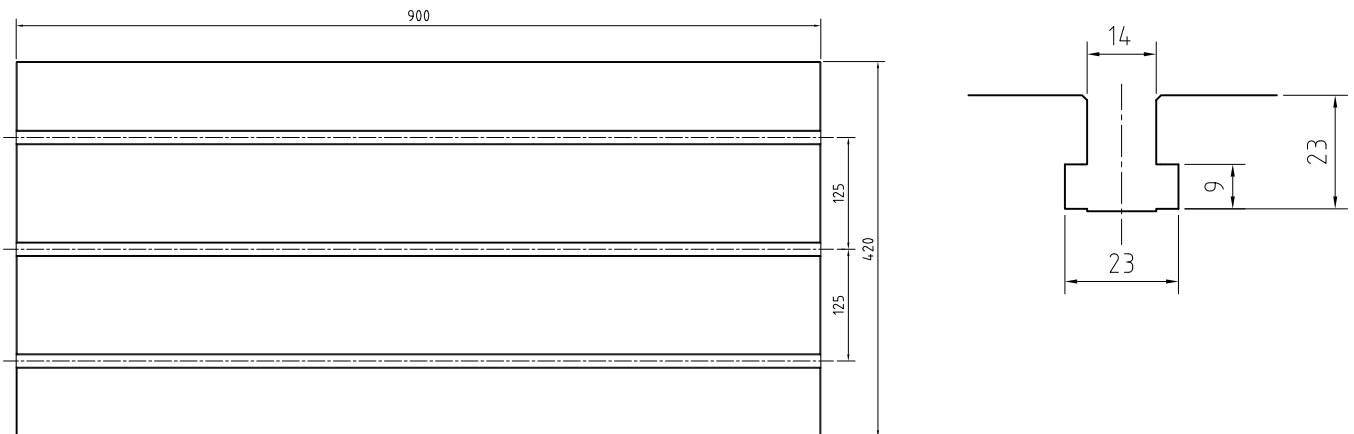

Dimensions

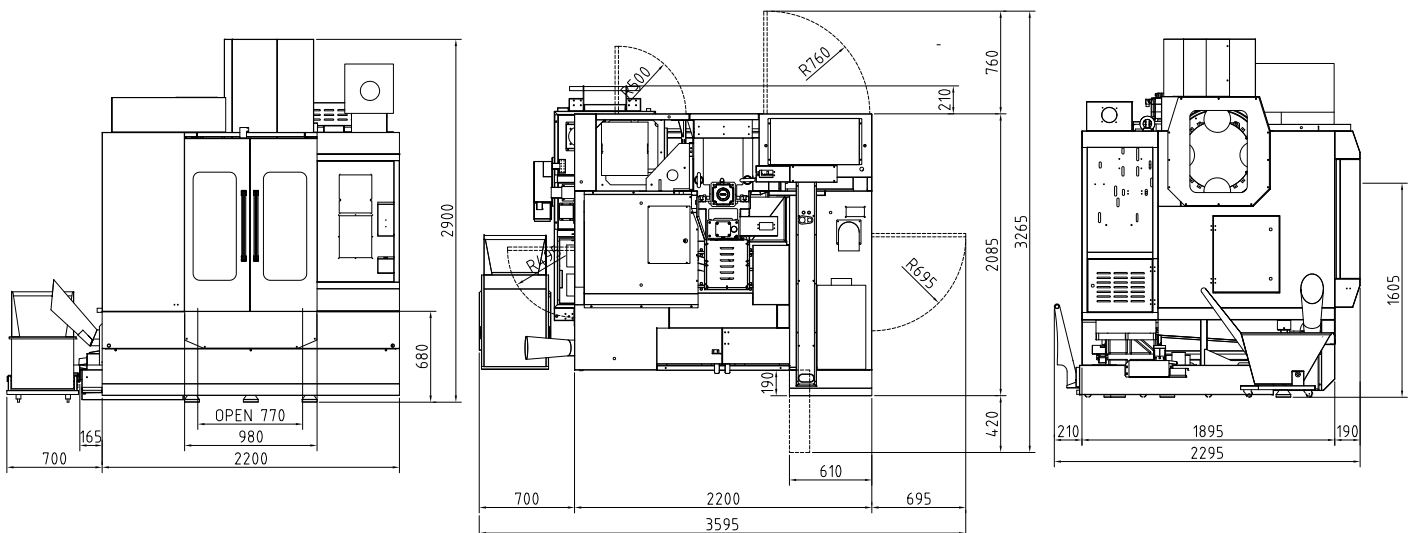

* The above specifications are subject to change without prior notice, no liability for mistakes. Machines may be shown with optional equipment.

Delta Center V10L



- Cast iron is tempered for stress relief to ensure structural stability without deformation
- Pre-tension on all axes minimizes thermal distortion
- C3 class ballscrews ensures the highest accuracy and durability



Technical Specifications		Delta Center V10L
Table		
Table size	mm	1100 x 500
T-slot (width x number x distance)	mm	18 x 5 x 100
Max. load	kg	600
Travel		
X/Y/Z Travel	mm	1020 / 530 / 560
Spindle nose to table	mm	115 - 675
Spindle center to column	mm	566
Spindle		
Spindle taper	-	SK 40 / BT 40 / CAT 40
Spindle speed	rpm	10000
Spindle motor power/torque	-	7.5/15kW; 36/72Nm (SIEMENS) 7.5/15kW; 35.8/95.5Nm (FANUC)
Tool changer		
Number of tools	pcs	24
Max. tool diameter	mm	Φ78 / Φ125
Max. tool length	mm	300
Max. tool weight	kg	8
Feed		
Rapid feed X/Y/Z	m/min	30
Cutting speed	mm/min	1-12000
Accuracy (VDI 3441 Full travel)		
Positioning accuracy	mm	0.010
Positioning repeatability	mm	0.006
Dimensions & Weight		
Dimensions	mm	3870x2175x2850
Weight	kg	5000

- Standard configuration**
- ✓ Fully enclosed splash guard
 - ✓ Belt drive spindle 10000 rpm
 - ✓ 24 pockets arm tool changer
 - ✓ Chain type chip conveyor
 - ✓ Air-conditioned electrical cabinet
 - ✓ Rigid tapping
 - ✓ Ethernet, CF card and USB interface
 - ✓ Automatic lubrication system
 - ✓ Coolant system
 - ✓ LED working lamp
 - ✓ End of program light
 - ✓ Electronic handwheel (MPG)
 - ✓ Tool box
 - ✓ Leveling bolts and blocks
 - ✓ Coolant gun
 - ✓ Air gun
 - ✓ Chip flushing system
 - ✓ User Manual

- Optional configuration**
- Direct drive spindle 12000 rpm
 - Spindle oil cooler
 - CTS Coolant through spindle + ATS
 - Oil skimmer
 - Workpiece probe
 - Tool probe
 - 4th axis
 - 4/5th axis

Worktable

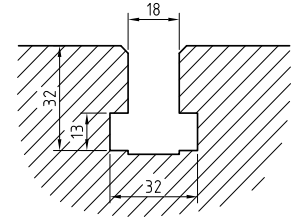
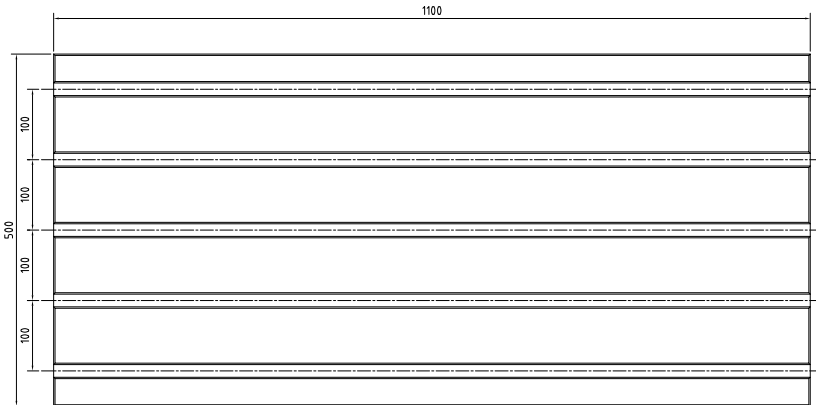

Dimensions

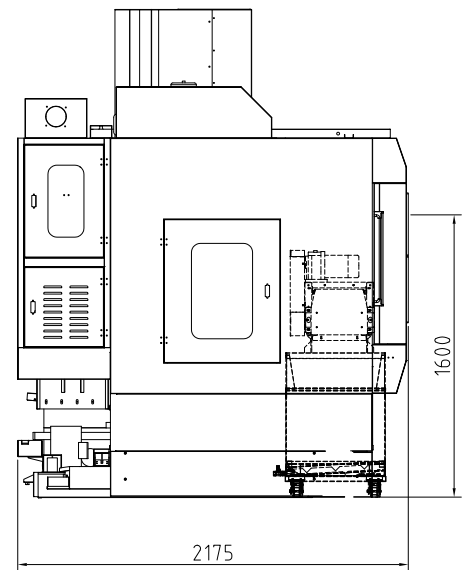
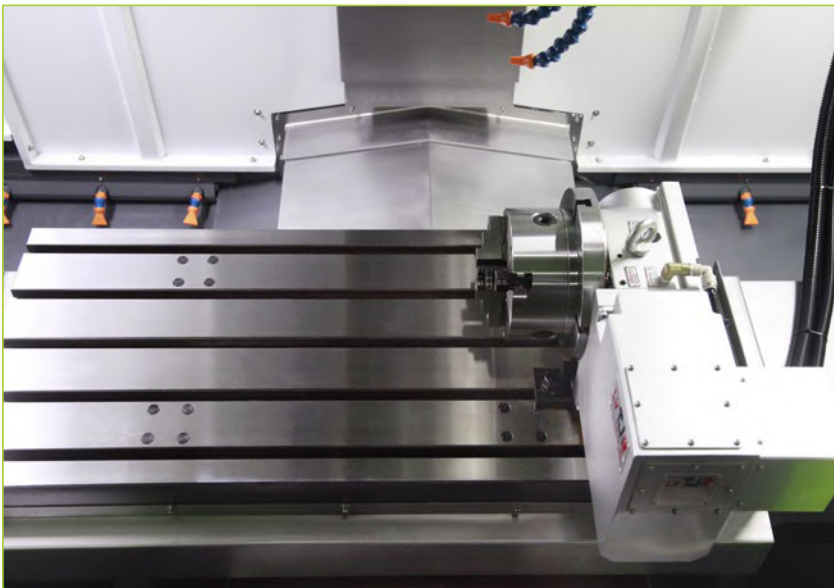
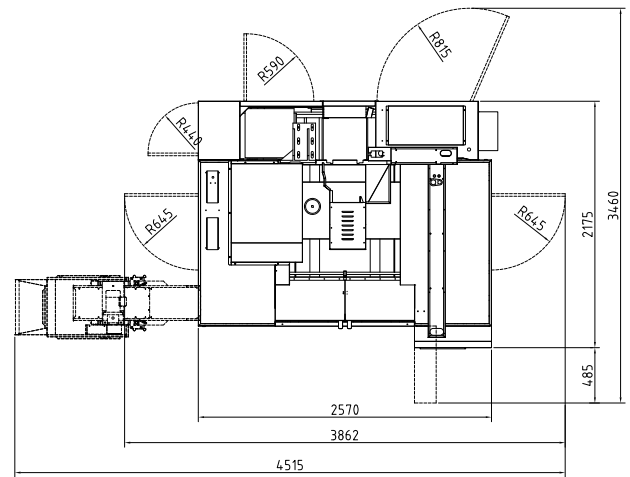
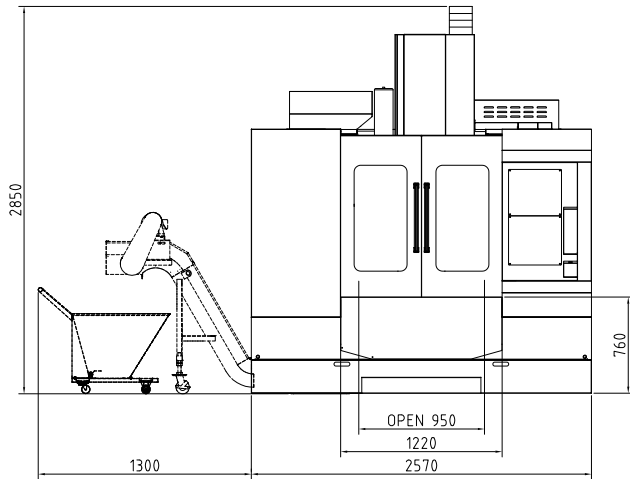

4th axis, different sizes

* The above specifications are subject to change without prior notice, no liability for mistakes. Machines may be shown with optional equipment.

Alpha Center V7L



Technical Specifications		Alpha Center V7L
Table		
Table size	mm	900 x 420
T-slot (width x number x distance)	mm	14 x 3 x 125
Max. load	kg	500
Travel		
X/Y/Z Travel	mm	760 / 450 / 520
Spindle nose to table	mm	100 - 620
Spindle center to column	mm	517
Spindle		
Spindle taper	-	SK 40 / BT 40 / CAT 40
Spindle speed	rpm	10000
Spindle motor power/torque	-	9/22kW; 63/135Nm (SIEMENS) 7.5/15kW; 35.8/95.5Nm (FANUC)
Feed		
Rapid feed X/Y/Z	m/min	48
Cutting speed	mm/min	1-12000
Tool changer		
Number of tools	pcs	24
Max. tool length	mm	300
Max. tool diameter	mm	Φ78 / Φ125
Max. tool weight	kg	8
Accuracy (VDI 3441 Full travel)		
Positioning accuracy	mm	0.008
Positioning repeatability	mm	0.006
Dimensions & Weight		
Dimensions	mm	3250x2710x2900
Weight	kg	4500



Standard configuration

- ✓ Fully enclosed splash guard
- ✓ Belt drive spindle 10000 rpm
- ✓ 24 pockets arm tool changer
- ✓ Chain type chip conveyor
- ✓ Air-conditioned electrical cabinet
- ✓ Rigid tapping
- ✓ Ethernet CF card and USB interface
- ✓ Automatic lubrication system
- ✓ Coolant system
- ✓ LED working lamp
- ✓ End of program light
- ✓ Electronic handwheel (MPG)
- ✓ Tool box
- ✓ Leveling bolts and blocks
- ✓ Coolant gun
- ✓ Air gun
- ✓ Chip flushing system
- ✓ User Manual

Optional configuration

- Direct drive spindle 12000 rpm
- 28 pockets arm tool changer
- Spindle oil cooler
- CTS Coolant through spindle + ATS
- Oil skimmer
- Workpiece probe
- Tool probe
- 4th axis
- 4/5th axis
- Extra 200GB SSD program memory (Only available on SIEMENS Control)

Worktable

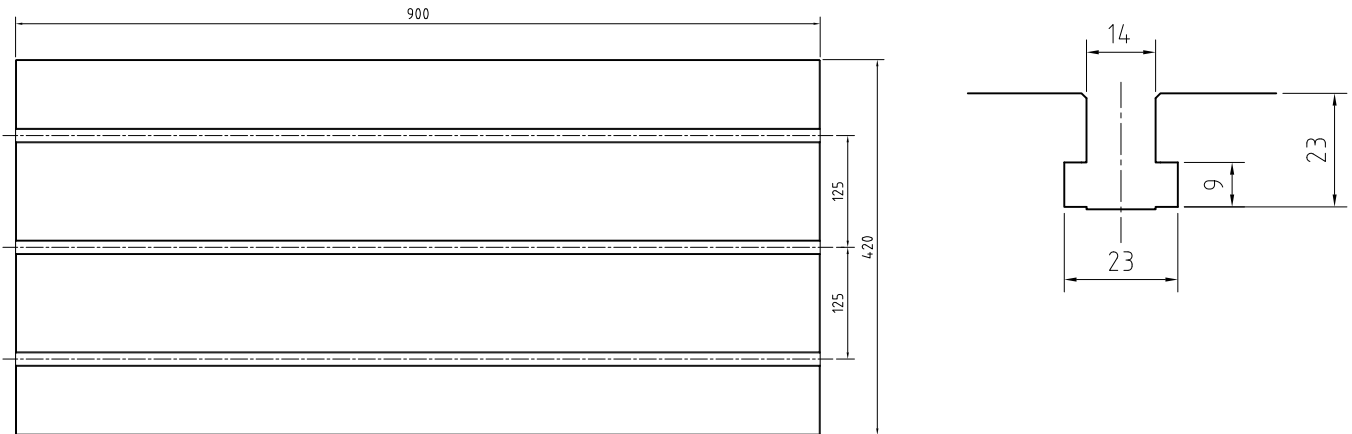

Dimensions

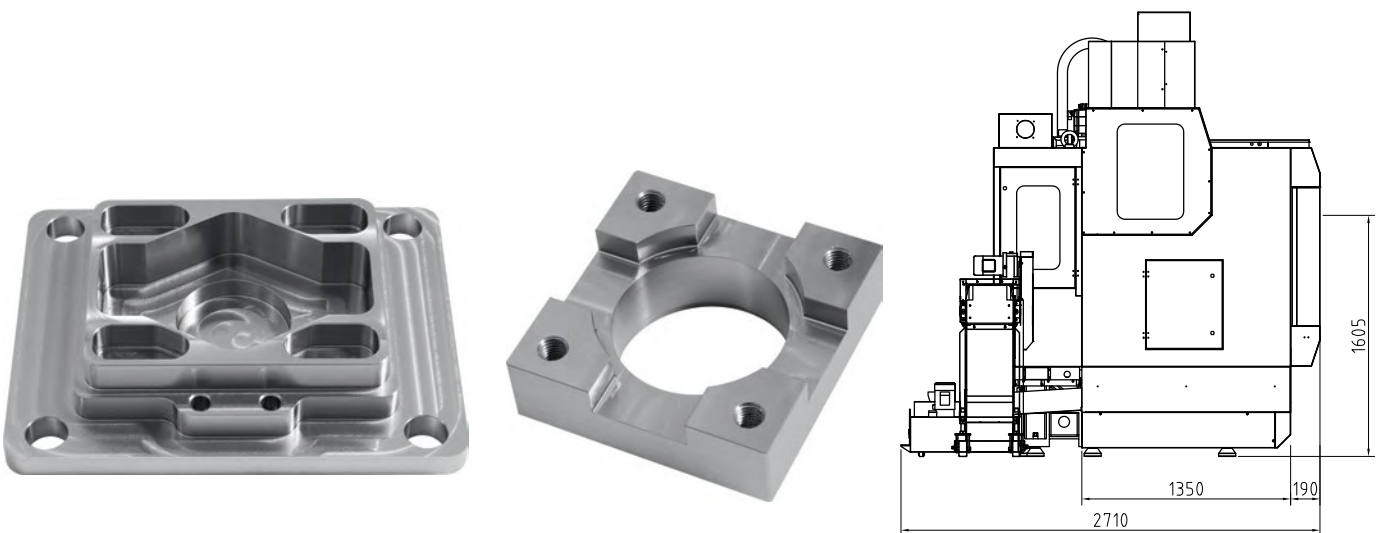
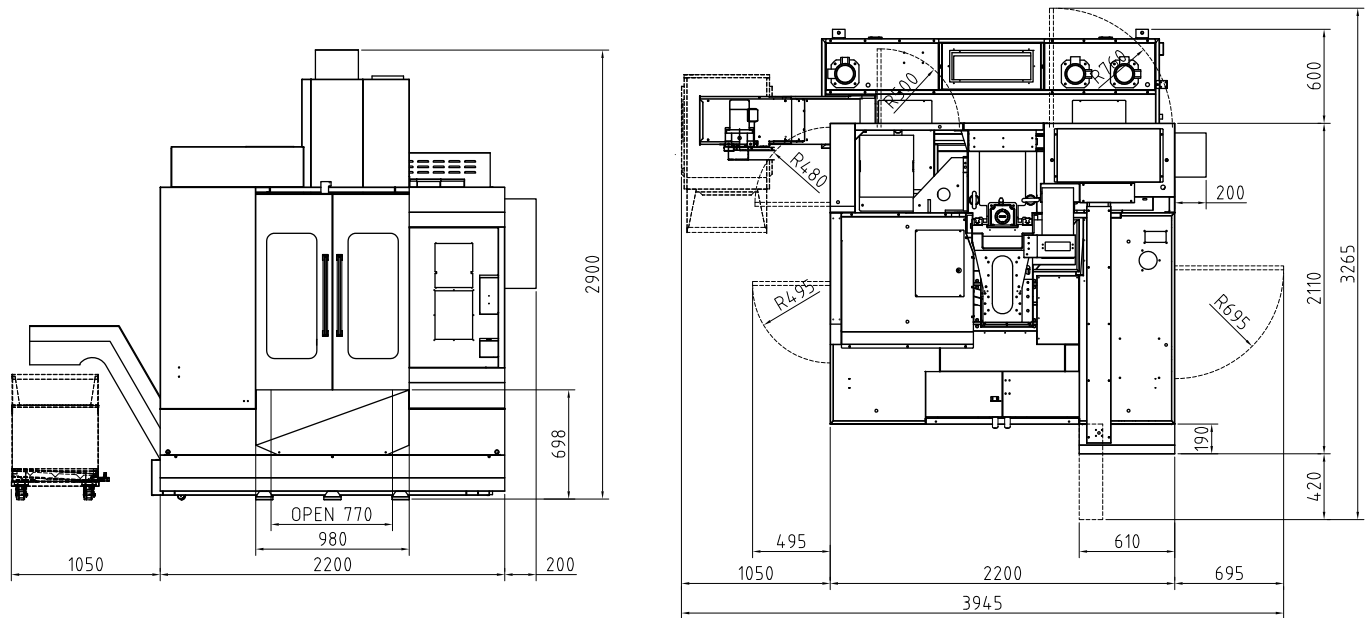

* The above specifications are subject to change without prior notice, no liability for mistakes. Machines may be shown with optional equipment.

Alpha Center V9L · V11L



- Cast iron is tempered for stress relief to ensure structural stability without deformation
- C3 class ballscrews ensures the highest accuracy and durability
- Pre-tension on all axis minimizes thermal distortion

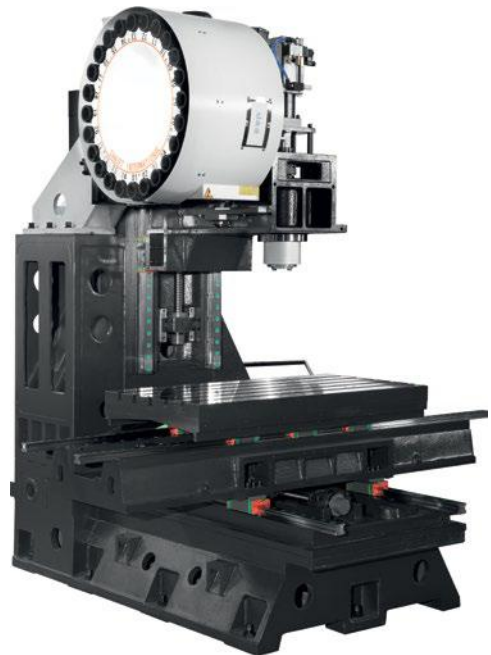

Technical Specifications		V9L	V11L
Table			
Table size	mm	1060 x 600	1200 x 600
T-slots (width x number x distance)	mm	18 x 5 x 100	
Max. load	kg	800	1000
Travel			
X/Y/Z Travel	mm	900 / 600 / 600	1100 / 600 / 600
Spindle nose to table	mm	150 - 750	
Spindle center to column	mm	652	
Spindle			
Spindle taper	-	SK 40 / BT 40 / CAT 40	
Spindle motor power/torque	-	9/22kW; 63/135Nm (SIEMENS) 11/18.5kW; 52.5/118Nm (FANUC)	
Spindle speed	rpm	10000	
Feed			
Rapid feed X/Y/Z	m/min	36	
Cutting speed	mm/min	1-12000	
Tool changer			
Number of tools	pcs	24	
Max. tool length	mm	300	
Max. tool diameter	mm	Φ78 / Φ125	
Max. weight	kg	8	
Accuracy (VDI 3441 Full travel)			
Positioning accuracy	mm	0.008	
Positioning repeatability	mm	0.006	
Dimensions & Weight			
Dimensions	mm	3845x2320x3120	
Weight	kg	6300	6500

Standard configuration

- ✓ Fully enclosed splash guard
- ✓ Belt drive spindle 10000 rpm
- ✓ 24 pockets arm tool changer
- ✓ Chain type chip conveyor
- ✓ Air-conditioned for electrical cabinet
- ✓ Rigid tapping
- ✓ Ethernet, CF card and USB interface
- ✓ Automatic lubrication system
- ✓ Coolant system
- ✓ LED working lamp
- ✓ End of program light
- ✓ Electronic handwheel (MPG)
- ✓ Tool box
- ✓ Leveling bolts and blocks
- ✓ Coolant gun
- ✓ Air gun
- ✓ Chip flushing system
- ✓ User Manual

Optional configuration

- Direct drive spindle 12000 rpm
- Direct drive spindle 15000 rpm
- 28 pockets arm tool changer
- Spindle oil cooler
- CTS Coolant through spindle + ATS
- Oil skimmer
- Workpiece probe
- Tool probe
- 4th axis
- 4/5th axis
- Extra 200GB SSD program memory (Only available on SIEMENS Control)

Worktable (V11L)

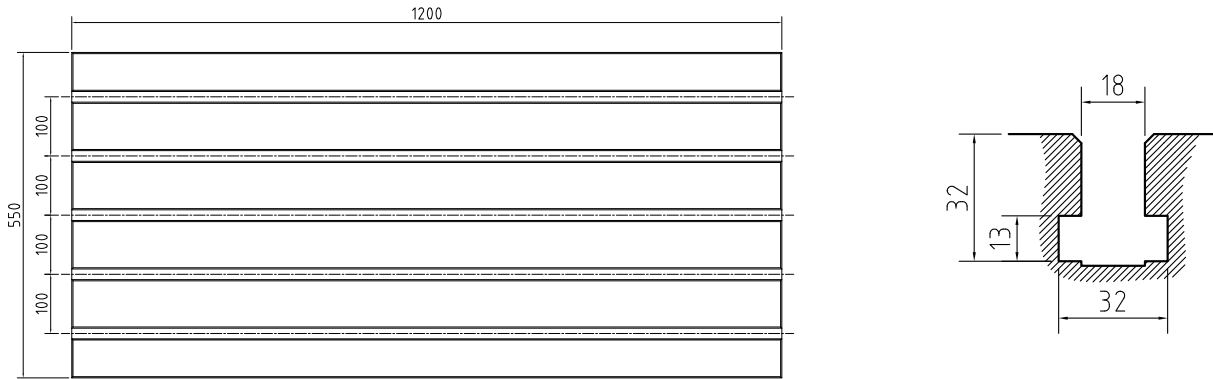

Dimensions (V11L)

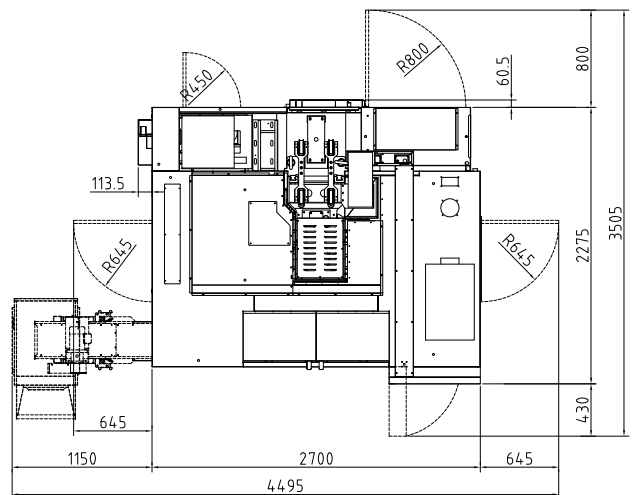
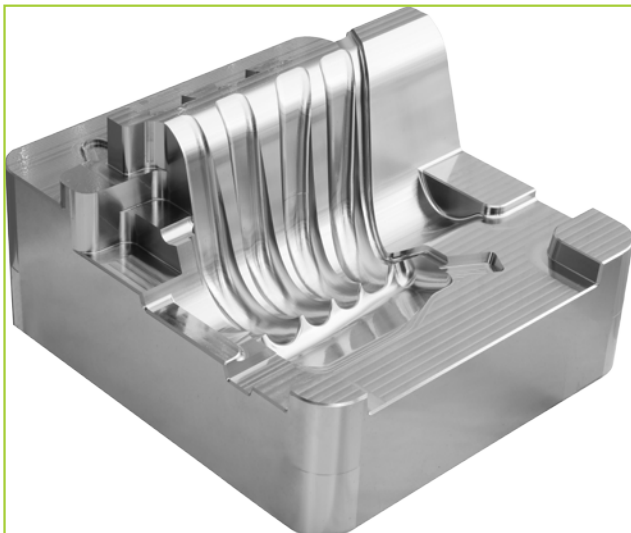
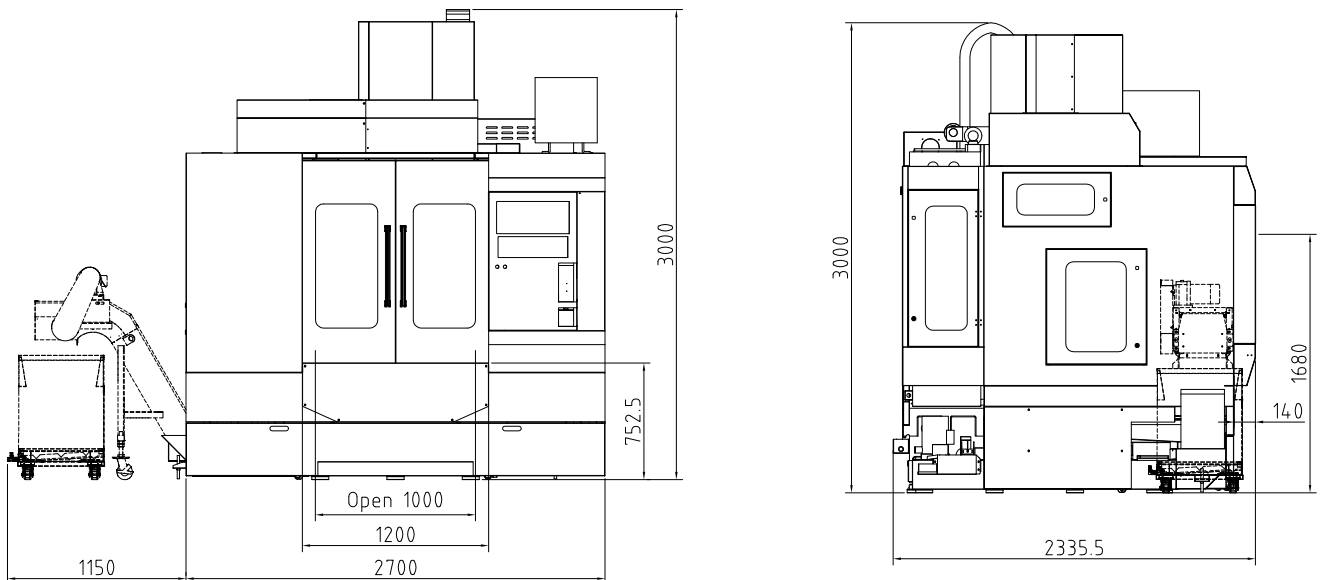

* The above specifications are subject to change without prior notice, no liability for mistakes. Machines may be shown with optional equipment.

Alpha Center V13L · V15L



- Cast iron is tempered for stress relief to ensure structural stability without deformation
- C3 class ballscrews ensures the highest accuracy and durability
- Pre-tension on all axis minimizes thermal distortion

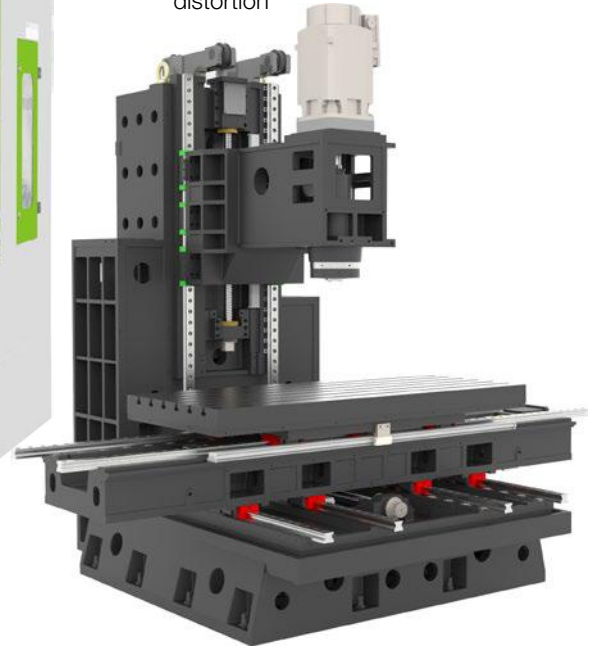

V15L frame with Y axis four linear guideways

Technical Specifications	V13L	V15L
Table		
Table size	mm	1500 x 650
T-slot (width x number x distance)	mm	18 x 5 x 100
Max. load	kg	1200
Travel		
X / Y / Z Travel	mm	1300 / 650 / 600
Spindle nose to table	mm	150 - 750
Spindle center to column	mm	697
Spindle		
Spindle taper	-	SK40/BT40/CAT40
Spindle speed	rpm	10000
Spindle motor power/torque	-	20/53kW; 126/250Nm (SIEMENS) 11/18.5kW; 52.5/118Nm (FANUC)
Tool changer		
Number of tools	pcs	24
Max. tool length	mm	300
Max. tool diameter	mm	Φ78 / Φ125
Max. tool weight	kg	8
Feed		
Rapid feed X/Y/Z	m/min	36/36/24
Cutting speed	mm/min	1-12000
Accuracy (VDI 3441 Full travel)		
Positioning accuracy	mm	0.010
Positioning repeatability	mm	0.006
Dimensions & Weight		
Dimensions	mm	4025x3090x3185
Weight	kg	8000

Standard configuration

- ✓ Fully enclosed splash guard
- ✓ Belt drive spindle 10000 rpm
- ✓ 24 pockets arm tool changer
- ✓ Chain type chip conveyor
- ✓ Air-conditioned electrical cabinet
- ✓ Rigid tapping
- ✓ Ethernet, CF card and USB interface
- ✓ Automatic lubrication system
- ✓ Coolant system
- ✓ LED working lamp
- ✓ End of program light
- ✓ Electronic handwheel (MPG)
- ✓ Tool box
- ✓ Leveling bolts and blocks
- ✓ Coolant gun
- ✓ Air gun
- ✓ Air blast during cutting
- ✓ User Manual

Optional configuration

- Belt drive spindle 6000 rpm BT50
- Belt drive spindle 8000 rpm BT50 (Only available on V13L)
- Direct drive spindle 12000rpm
- Direct drive spindle 15000 rpm (Only available on SIEMENS and HEIDENHAIN)
- 28 pockets arm tool changer ,taper 40
- 40 pockets chain type tool changer ,taper 40
- Spindle oil cooler
- CTS Coolant through spindle + ATS
- Oil skimmer
- Workpiece probe
- Tool probe
- 4th axis
- 4/5th axis
- Extra 200GB SSD program memory (Only available on SIEMENS Control)

* The above specifications are subject to change without prior notice, no liability for mistakes. Machines may be shown with optional equipment.

Worktable (V15L)

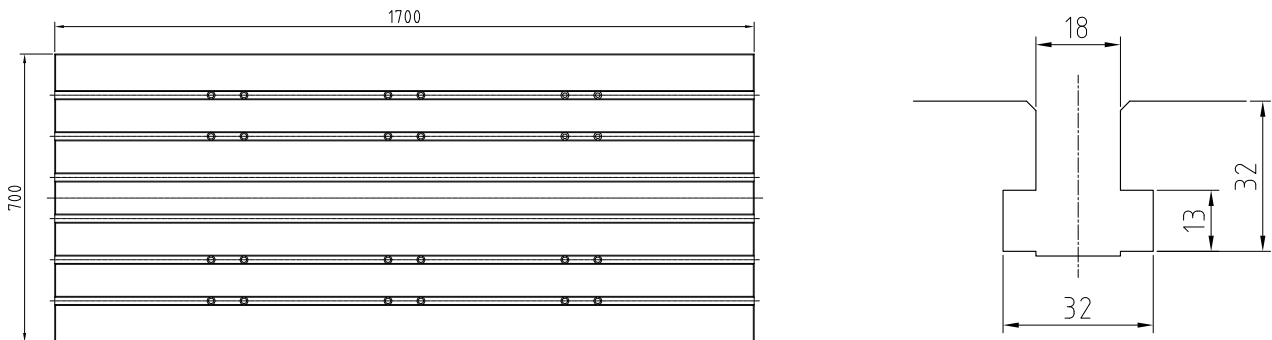

Dimensions (V15L)

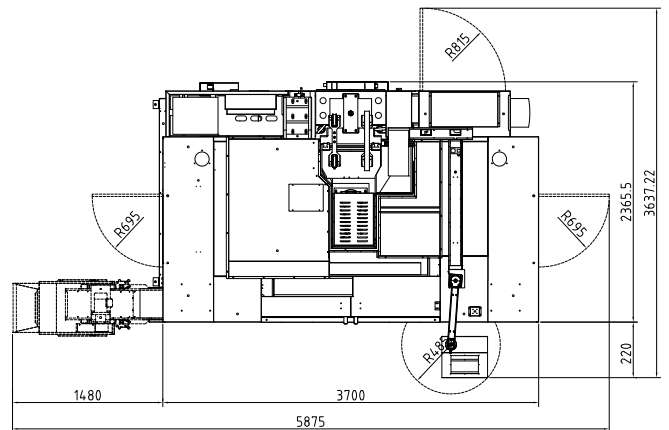
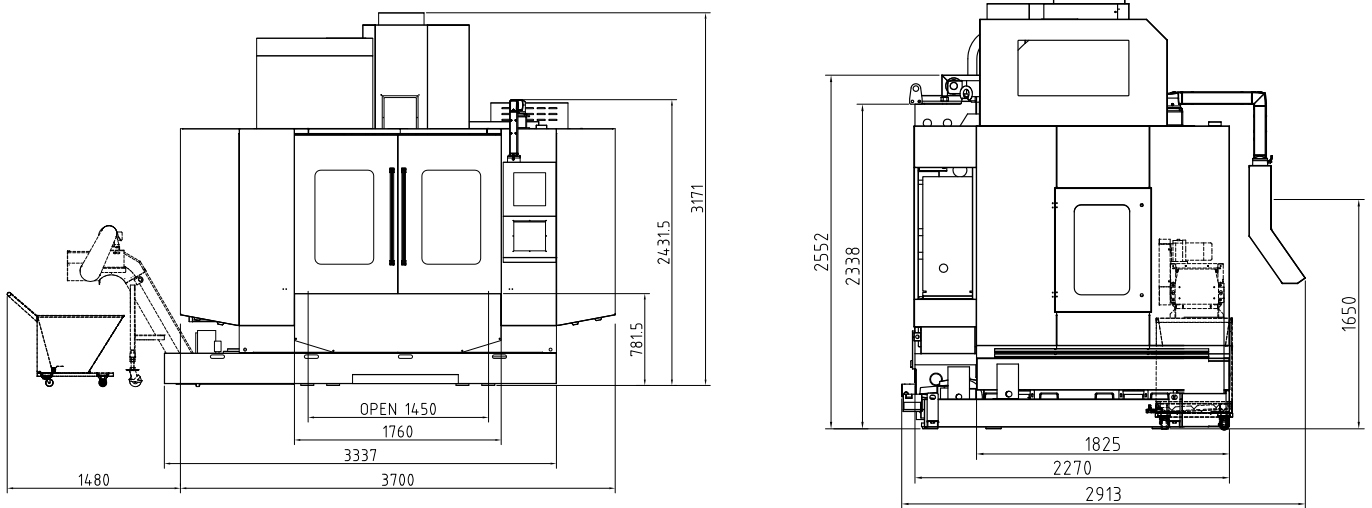

5th axis, different sizes

* The above specifications are subject to change without prior notice, no liability for mistakes. Machines may be shown with optional equipment.

Power Center V18

- Best choice for super heavy duty cutting with large workpiece
- X and Y axis with roller type linear guideways and Z axis with boxway guideways
- 50 taper spindle with belt drive 6000 rpm as standard, and optional with gearbox



- C3 class ballscrews ensures the highest accuracy and durability
- Pre-tension on all axis minimizes thermal distortion

Technical Specifications		Power Center V18
Table		
Table size	mm	2000 x 900
T-slot (width x number x distance)	mm	22 x 5 x 165
Max. load	kg	2000
Travel		
X / Y / Z Travel	mm	1800 / 900 / 600
Spindle nose to table	mm	160 - 760
Spindle center to column	mm	950
Spindle		
Spindle taper	-	SK 50 / BT 50 / CAT 50
Spindle motor power/torque	-	22/60kW; 172/380Nm (SIEMENS) 15/18.5kW; 143/259Nm (FANUC)
Spindle speed	rpm	6000
Feed		
Rapid speed X/Y/Z	m/min	20/20/15
Cutting speed	mm/min	1-12000
Tool changer		
Number of tools	pcs	24
Max. tool length	mm	400
Max. tool diameter	mm	Φ125 / Φ245
Max. tool weight	kg	15
Accuracy (VDI 3441 Full travel)		
Positioning accuracy	mm	0.016
Positioning repeatability	mm	0.010
Dimensions & Weight		
Dimensions	mm	6050x3270x3650
Weight	kg	17500

- Standard configuration**
- ✓ Fully enclosed splash guard
 - ✓ Belt drive spindle 6000 rpm
 - ✓ 24 pockets arm tool changer
 - ✓ Two screw type and one chain type chip conveyor
 - ✓ Air-conditioned electrical cabinet
 - ✓ Rigid tapping
 - ✓ Ethernet, CF card and USB interface
 - ✓ Automatic lubrication system
 - ✓ Coolant system
 - ✓ LED working lamp
 - ✓ End of program light
 - ✓ Electronic handwheel (MPG)
 - ✓ Tool box
 - ✓ Leveling bolts and blocks
 - ✓ Coolant gun
 - ✓ Air gun
 - ✓ Air blast during cutting
 - ✓ User Manual

- Optional configuration**
- Spindle oil cooler
 - Gear box spindle 6000 rpm
 - Z axis travel 720 mm (spindle nose to table 160-880 mm)
 - 32 pockets chain type tool changer
 - CTS Coolant through spindle + ATS
 - Oil skimmer
 - Workpiece probe
 - Tool probe
 - 4th axis
 - 4/5th axis
 - Extra 200GB SSD program memory (Only available on SIEMENS Control)

* The above specifications are subject to change without prior notice, no liability for mistakes. Machines may be shown with optional equipment.

Worktable

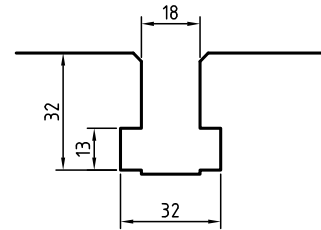
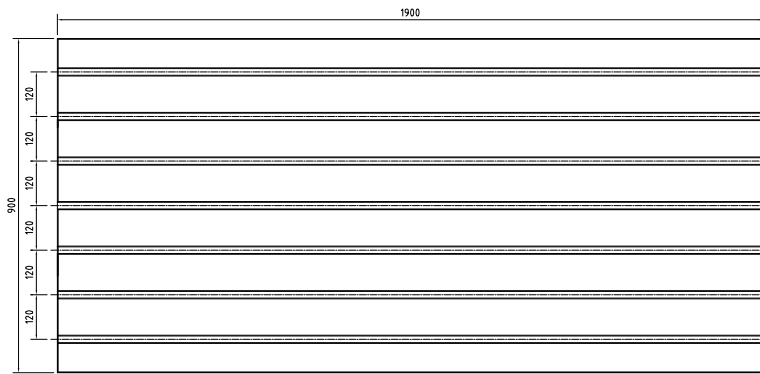

Dimensions

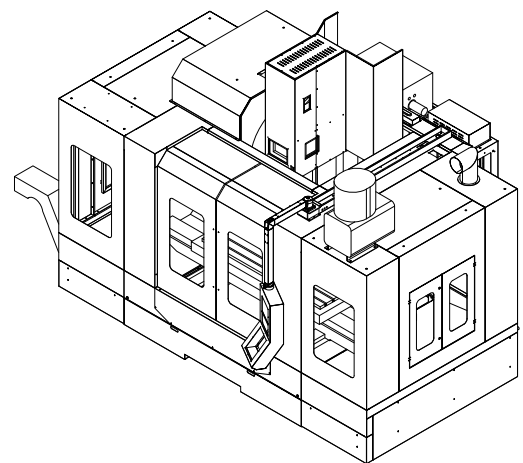
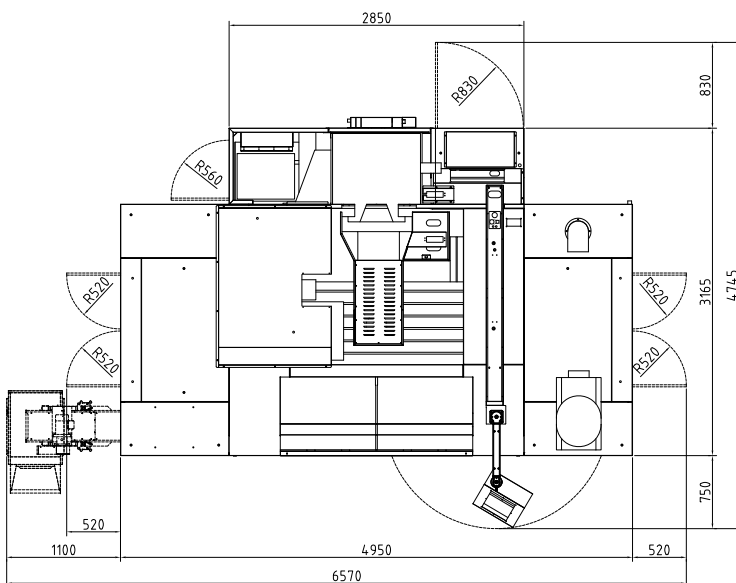
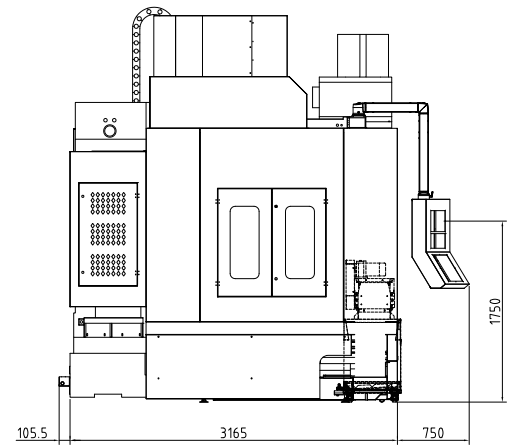
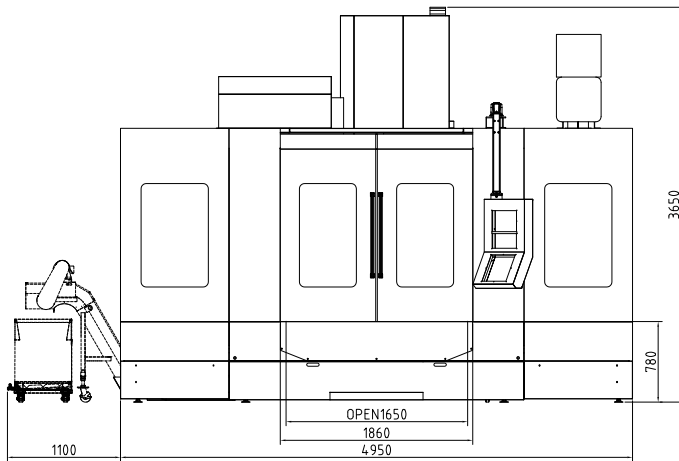

* The above specifications are subject to change without prior notice, no liability for mistakes. Machines may be shown with optional equipment.

Double Column Center V1613HS



- Cast iron is tempered for stress relief to ensure structural stability without deformation
- C3 class ballscrews ensures the highest accuracy and durability
- Pre-tension on all axes minimizes thermal distortion
- Roller type linear guideway, which offers super high rigidity and loading capacity

Standard configuration

- ✓ Fully enclosed splash guard
- ✓ Air-conditioned electrical cabinet
- ✓ Rigid tapping
- ✓ Two screw type and one chain type chip conveyor
- ✓ Ethernet, CF card and USB interface
- ✓ Automatic lubrication system
- ✓ Coolant system
- ✓ Spindle oil cooler
- ✓ LED working lamp
- ✓ End of program light
- ✓ Electronic handwheel (MPG)
- ✓ Tool box
- ✓ Leveling bolts and blots
- ✓ Coolant gun
- ✓ Air gun
- ✓ User Manual

Optional configuration

- Direct drive spindle 15000 rpm
- Built-in spindle 20000 rpm, HSK A63
- 32 pockets arm tool changer
- CTS coolant through spindle +ATS
- Linear scales
- Oil skimmer
- Extra 200GB SSD program memory (Only available on SIEMENS Control)

Technical Specifications		V1613HS
Table		
Table size	mm	1700 x 1200
T-slot (width x number x distance)	mm	18 x 7 x 150
Max. load	kg	3000
Travel		
X/Y/Z Travel	mm	1600 / 1300 / 600
Spindle nose to table	mm	200 - 800
Distance between columns	mm	1380
Spindle		
Spindle taper	-	SK40 / BT40 / CAT40
Spindle motor power/ torque	-	9/22kW; 63/135Nm (SIEMENS) 11/18.5kW; 52.5/118Nm (FANUC)
Spindle speed	rpm	12000
Spindle transmission	-	direct drive
Feed		
Rapid feed X/Y/Z	m/min	20
Cutting speed	mm/min	1-12000

Technical Specifications		V1613HS
Tool changer		
Number of tools	pcs	32 (option)
Max. tool length	mm	300
Max. tool diameter	mm	Φ78 / Φ125
Max. tool weight	kg	8
Accuracy (VDI 3441 Full travel)		
Positioning accuracy (without linear scales)	mm	0.012
Positioning repeatability (without linear scales)	mm	0.010
Positioning accuracy (with linear scales)	mm	0.010
Positioning repeatability (with linear scales)	mm	0.008
Dimensions & Weight		
Dimensions	mm	4890x4110x3650
Weight	kg	16000

* The above specifications are subject to change without prior notice, no liability for mistakes. Machines may be shown with optional equipment.

Worktable

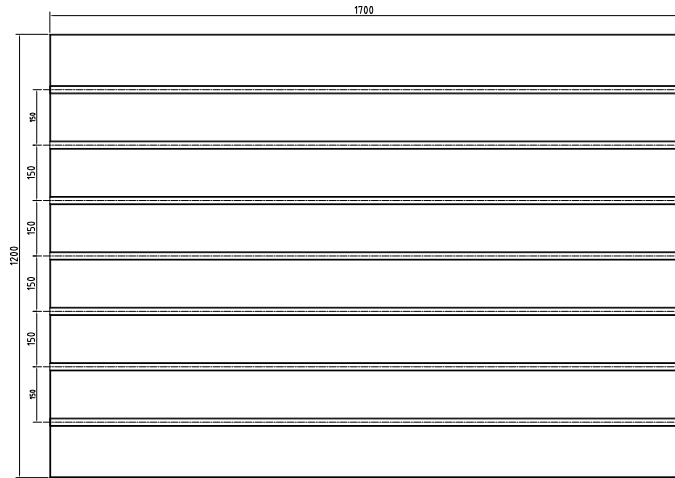

Dimensions (V1613HS)

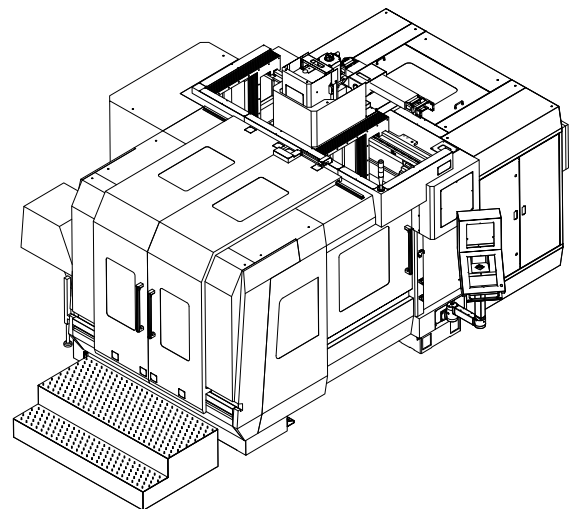
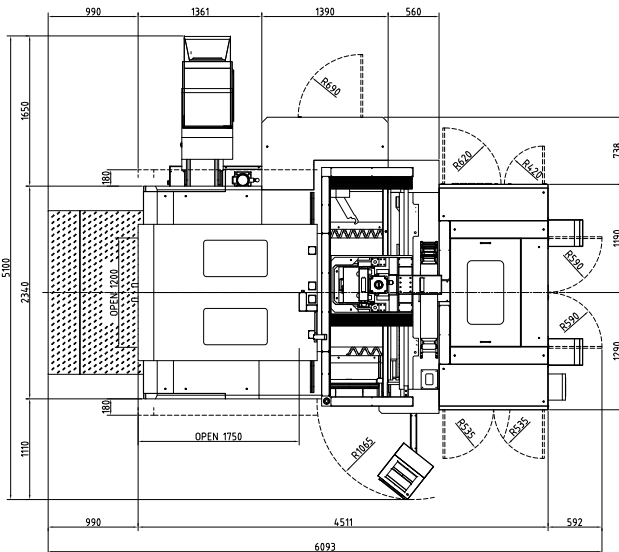
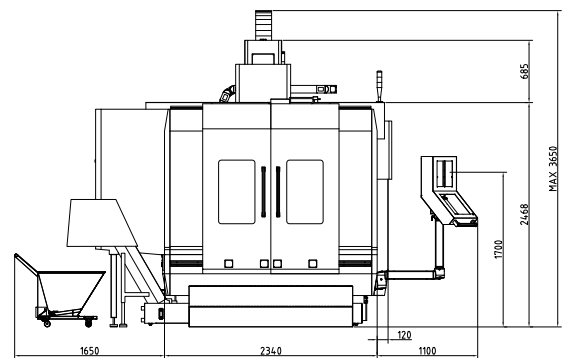
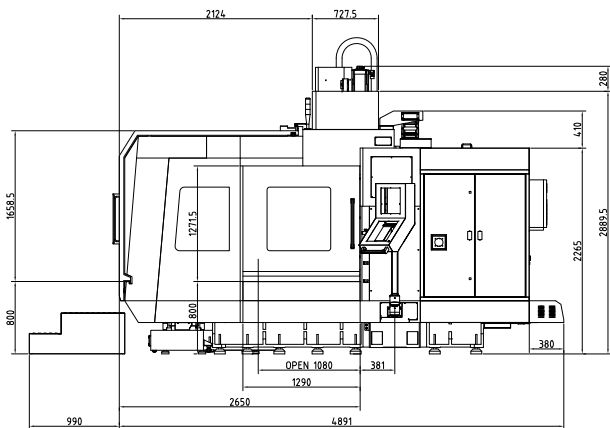

* The above specifications are subject to change without prior notice, no liability for mistakes. Machines may be shown with optional equipment.

Double Column Center V2015 · V3320 · V4028

- Extra wide column to increase connection surface with the crossbeam to avoid vibration during cutting.
- Roller type linear guideway, which offers super high rigidity and loading capacity



Technical Specifications		V2015	V3320	V4028
Table				
Table size	mm	2100×1200	3300×1700	4000×2400
T-slot (width x number x distance)	mm	22×7×150	22×9×180	28×11×200
Max. load	kg	4000	10000	12000
Travel				
X/Y/Z Travel	mm	2000/1500/800	3300/2700/1000	4200/3300/1200
Spindle nose to table	mm	170-970	200-1200	300-1500
Distance between columns	mm	1500	2000	2800
Spindle				
Spindle speed	rpm	BT50, 6000 rpm		
Power/torque (SIEMENS)	-	22/60 kW, 172/380 Nm		
Power/torque (FANUC)	-	15/18.5 kW, 143/259 Nm	22/45 kW, 140/286 Nm	
Spindle speed (optional, only available on SIEMENS)	rpm	/	HSK A100, 12000 rpm	
Power/torque	-	/	20/22.5 kW, 298/346 Nm	
Feed				
Rapid feed X/Y/Z	m/min	15/15/12	24/24/30	20
Cutting speed	mm/min	1-12000		
Accuracy (VDI3441 Full travel)				
Positioning accuracy (without linear scales)	mm	0.015	0.020/0.020/0.015 (X/Y/Z)	0.0250/0.020/0.015 (X/Y/Z)
Positioning repeatability (without linear scales)	mm	0.012	0.015/0.015/0.010 (X/Y/Z)	0.020/0.015/0.010 (X/Y/Z)
Positioning accuracy (with linear scales)	mm	/	0.015/0.015/0.010 (X/Y/Z)	0.020/0.015/0.010 (X/Y/Z)
Positioning repeatability (with linear scales)	mm	/	0.010/0.010/0.006 (X/Y/Z)	0.015/0.010/0.006 (X/Y/Z)
Dimensions & Weight				
Dimensions	mm	7090×4120×4250	10000×5700×5400	10500×6320×5850
Weight	kg	19000	30000	52000

* The above specifications are subject to change without prior notice, no liability for mistakes. Machines may be shown with optional equipment.

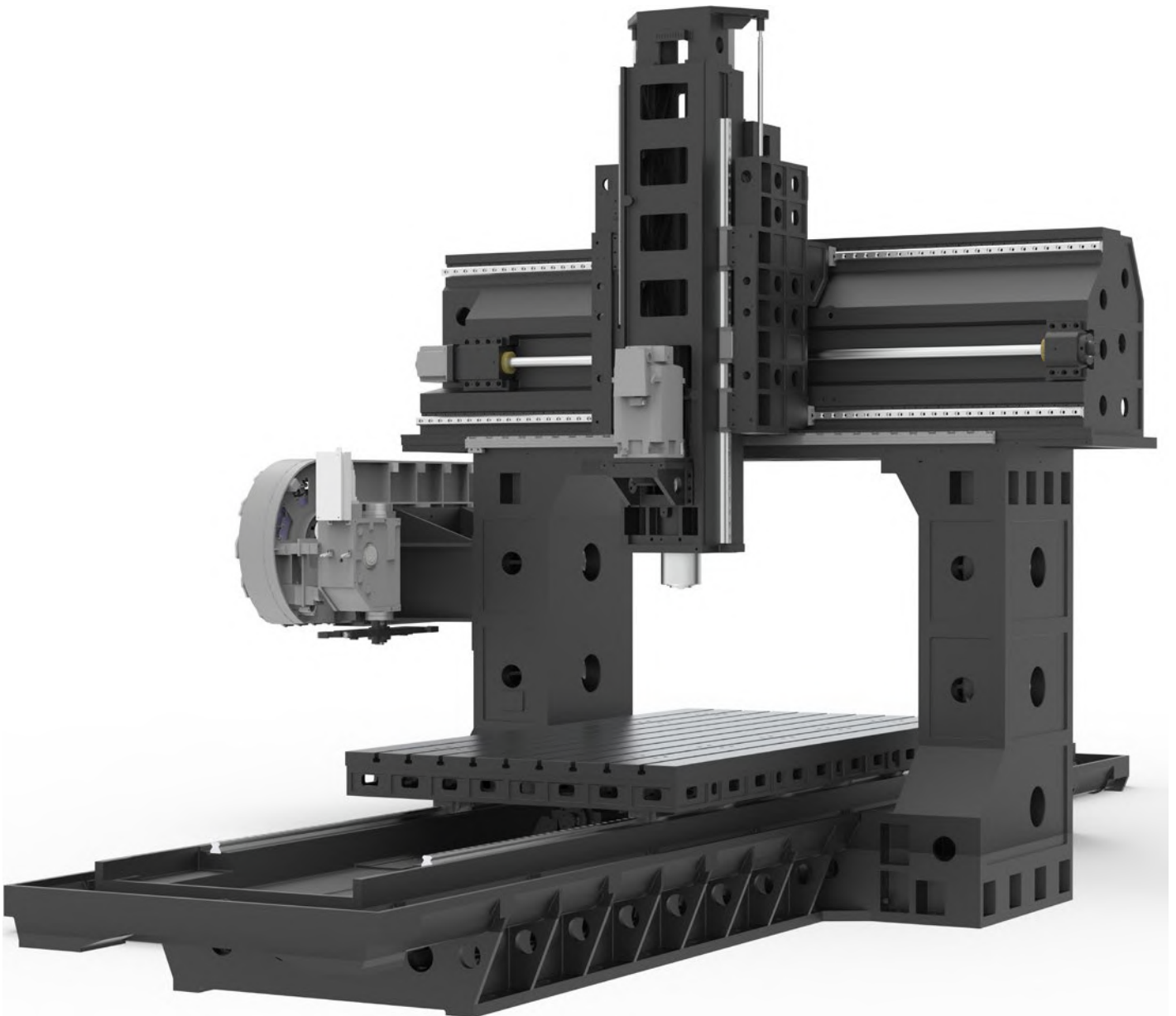

V3320 frame

Standard configuration

- ✓ Half enclosed splash guard
- ✓ Air-conditioned electrical cabinet
- ✓ Rigid tapping
- ✓ Chip conveyor (two screw type and one chain type)
- ✓ Ethernet, CF card and USB interface
- ✓ Automatic lubrication system
- ✓ Coolant system
- ✓ Spindle oil cooler
- ✓ LED working lamp
- ✓ End of program light
- ✓ Electronic handwheel (MPG)
- ✓ Tool box
- ✓ Leveling bolts and blots
- ✓ Coolant gun
- ✓ Air gun
- ✓ User Manual

Optional configuration

- Fully enclosed splash guard with top roof (Only available on V3320 and V4028)
- Built-in spindle 12000RPM, HSK A100 (Only available on V3320 and V4028 with SIEMENS Control)
- 24 pockets arm tool changer (Only available on V2015)
- 40/60 pockets chain type tool changer (Only available on V3320 and V4028)
- CTS coolant through spindle + ATS
- Gearbox
- Linear scales (Only available on V3320 and V4028)
- Extra 200GB SSD program memory (Only available on SIEMENS Control)

* The above specifications are subject to change without prior notice, no liability for mistakes. Machines may be shown with optional equipment.

Measurements control during the production

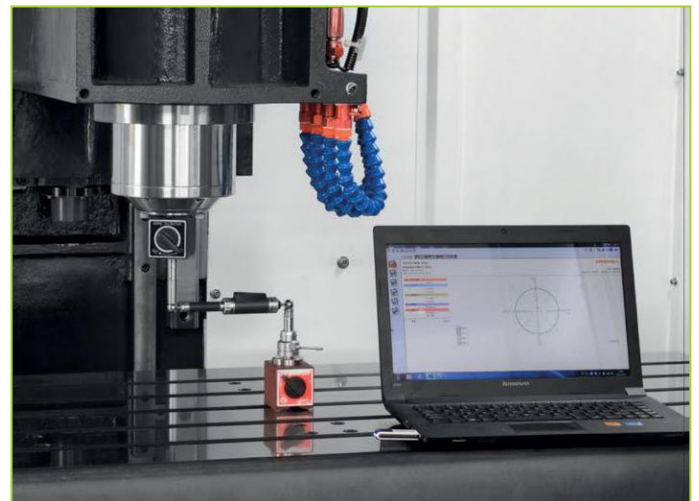

Spindle unit final unbalancing inspection

Hand scraping

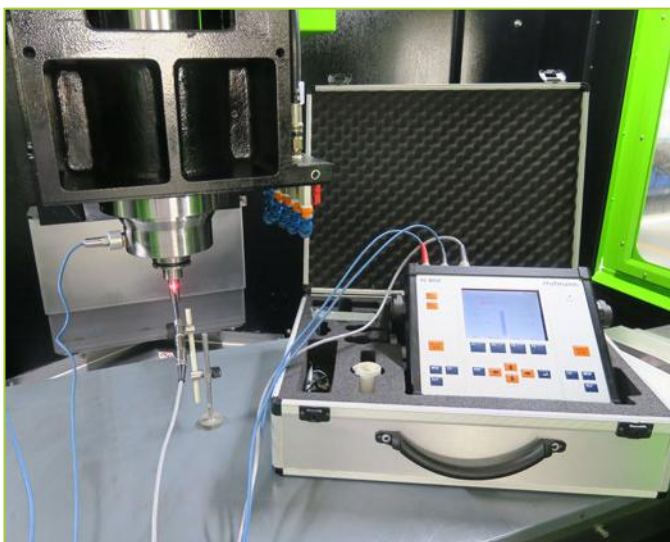

pl LEHMANN®



Swiss Rotary Table Technology

High speed

- ✓ Up to 210 rpm
- ✓ up to 0.21 sec / 90°

More space

- ✓ Extended travel in Z- and X-direction

Heavy duty

- ✓ High spindle load, heavy-duty bearing

High torque

- ✓ Feed torque up to 850 Nm

Adaptability

- ✓ Multifunctional spindle HSK

Precision

- ✓ On the workpiece, as precise as 2µm / 100 mm

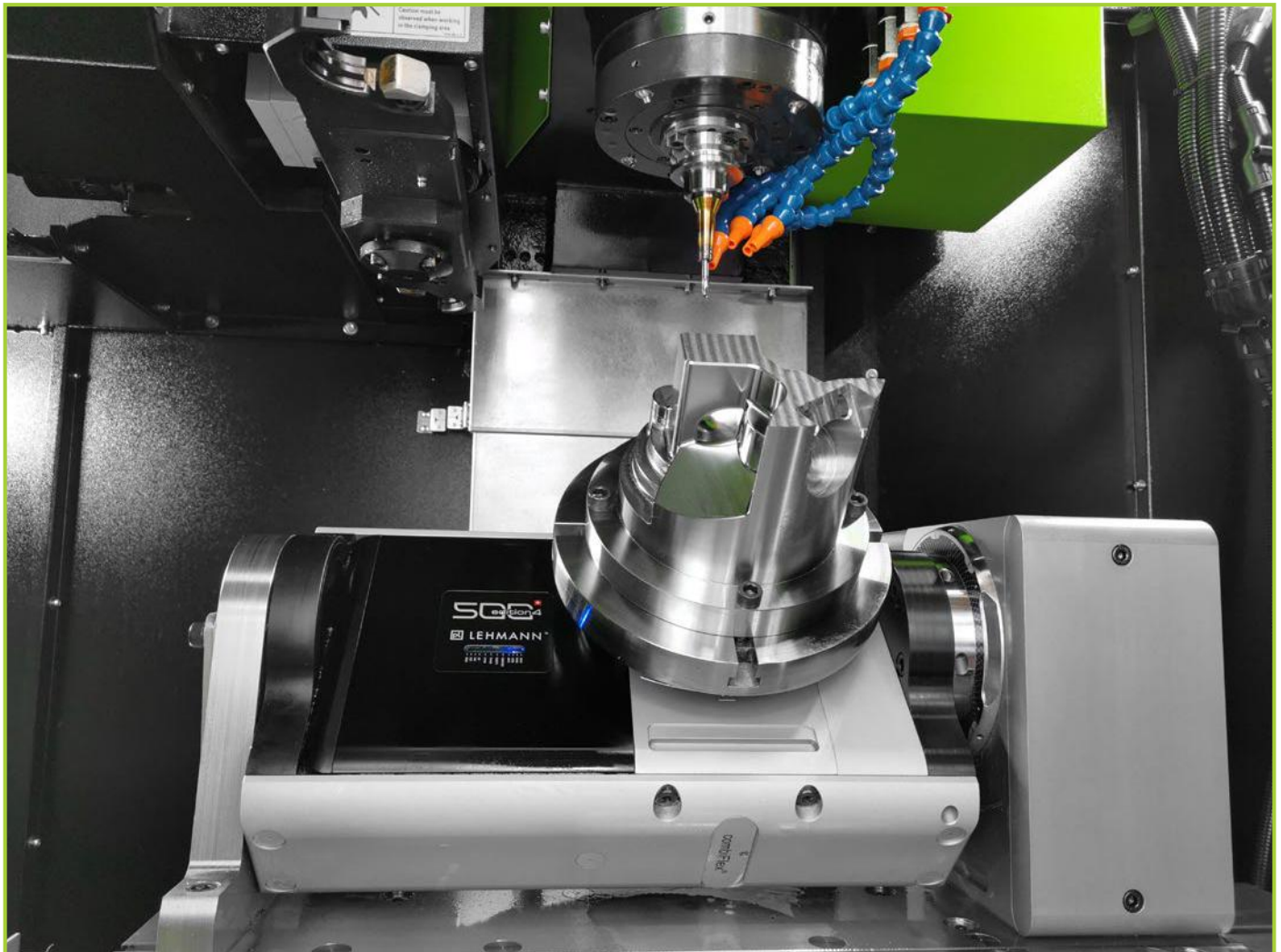

* The above specifications are subject to change without prior notice, no liability for mistakes. Machines may be shown with optional equipment.



SIEMENS



HEIDENHAIN



FANUC



FAGOR

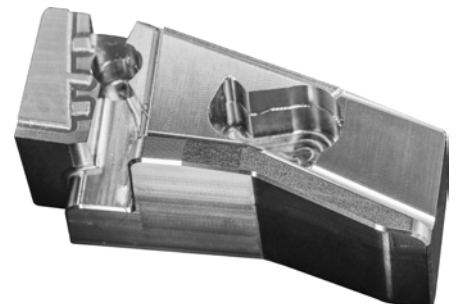
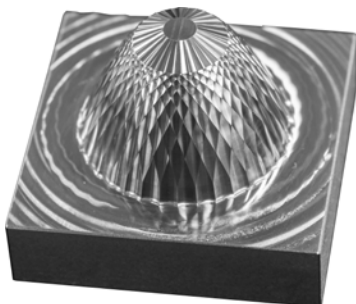
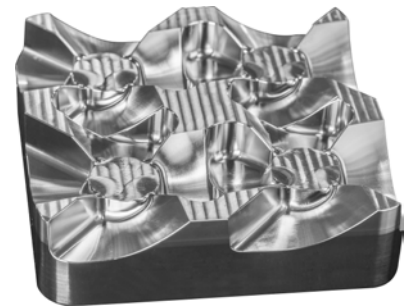
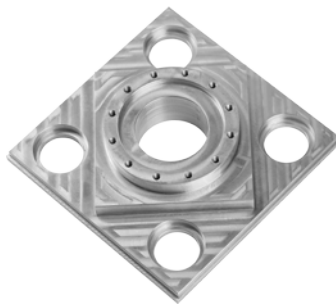
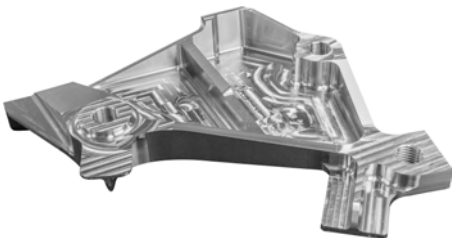
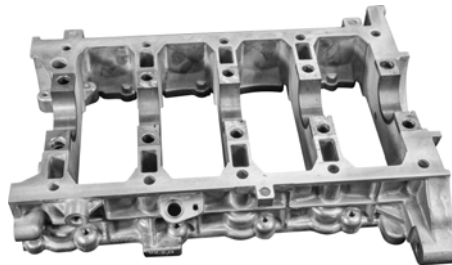
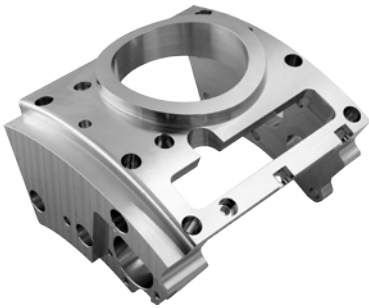



hyperMILL
SolidCAM
 The Leaders in Integrated CAM



DIJET NS TOOL
GÜHRING



LEHMANN



HAIMER



SCHUNK



Blaser.
 SWISSLUBE



REGO-FIX



BLUM
 focus on productivity



Workpiece measuring by CMM

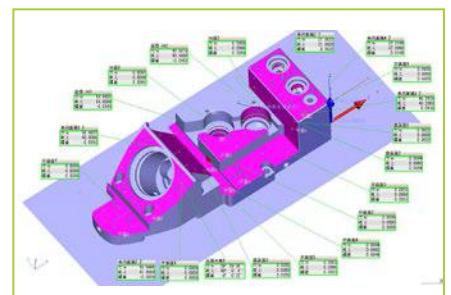
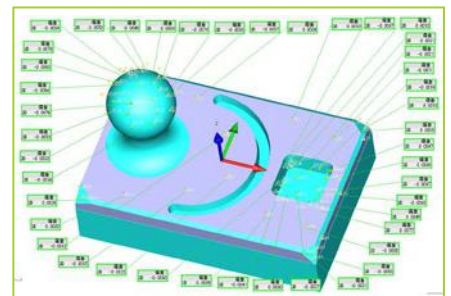
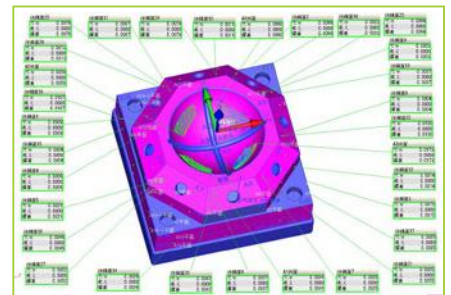
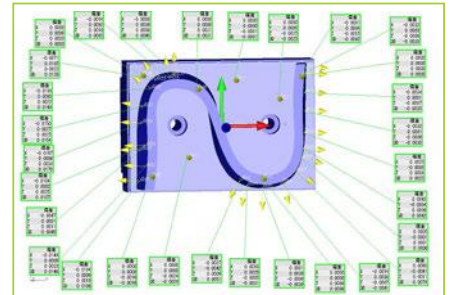

* The above specifications are subject to change without prior notice, no liability for mistakes. Machines may be shown with optional equipment.

PRIMINER

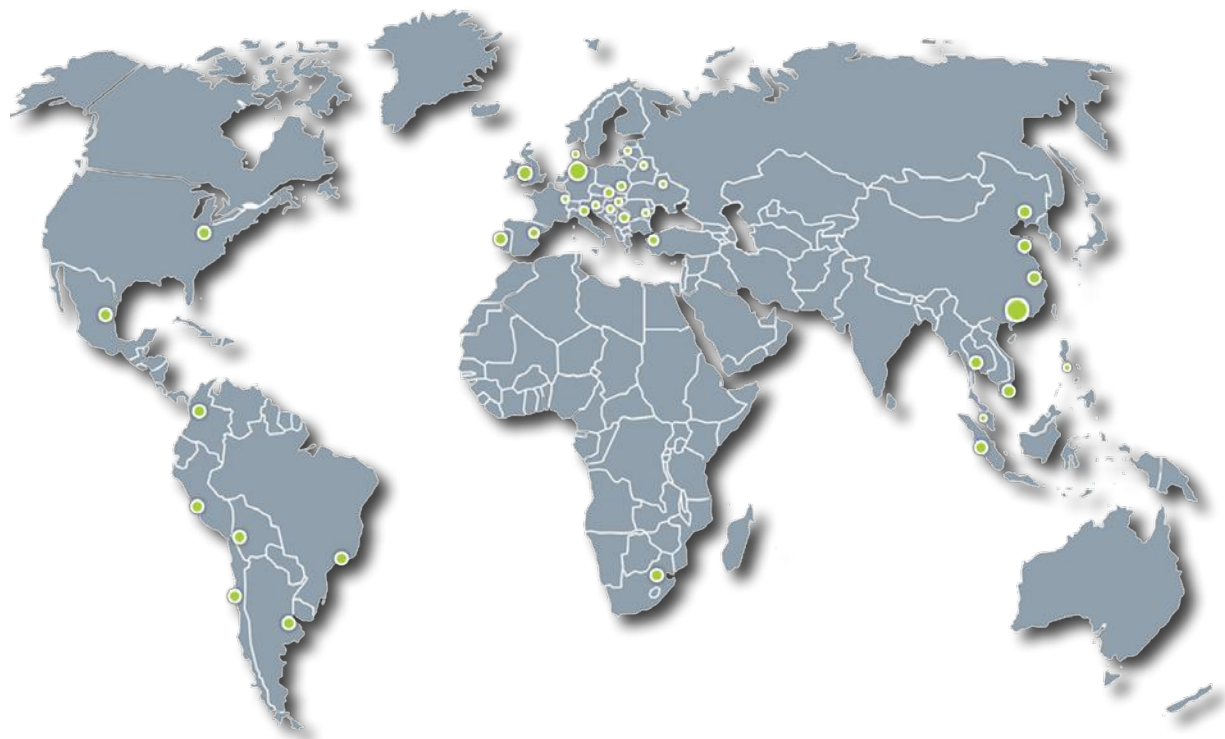

PRIMINER Werkzeugmaschinen GmbH

Gadelander Str. 172 · D-24539 Neumünster / Germany

Tel: +49 (0) 4321-53 9946-0

Fax: +49 (0) 4321-25 2003-90

E-mail: info@priminer.de

PRIMINER SOUTH EAST EUROPE · PRIMINER d.o.o. BEOGRAD

Vladimira Popovica 38-40 · GTC - 11070 Beograd / Srbija

Tel: +381 69 702 705

Fax: +381 11 715 69 00

E-mail: office@priminer.de

PRIMINER MACHINE TOOLS DONGGUAN CO., LTD

XinRuYi Industrial Park, Fuxing Road, Xingguang Village, Huangjiang Town, Dongguan, P.R.China

Tel: +86 769 838 490 61

Fax: +86 769 838 490 62

E-mail: sales@priminer.de

www.priminer.de